

MATCHLINE A SEE DRAWING L-3

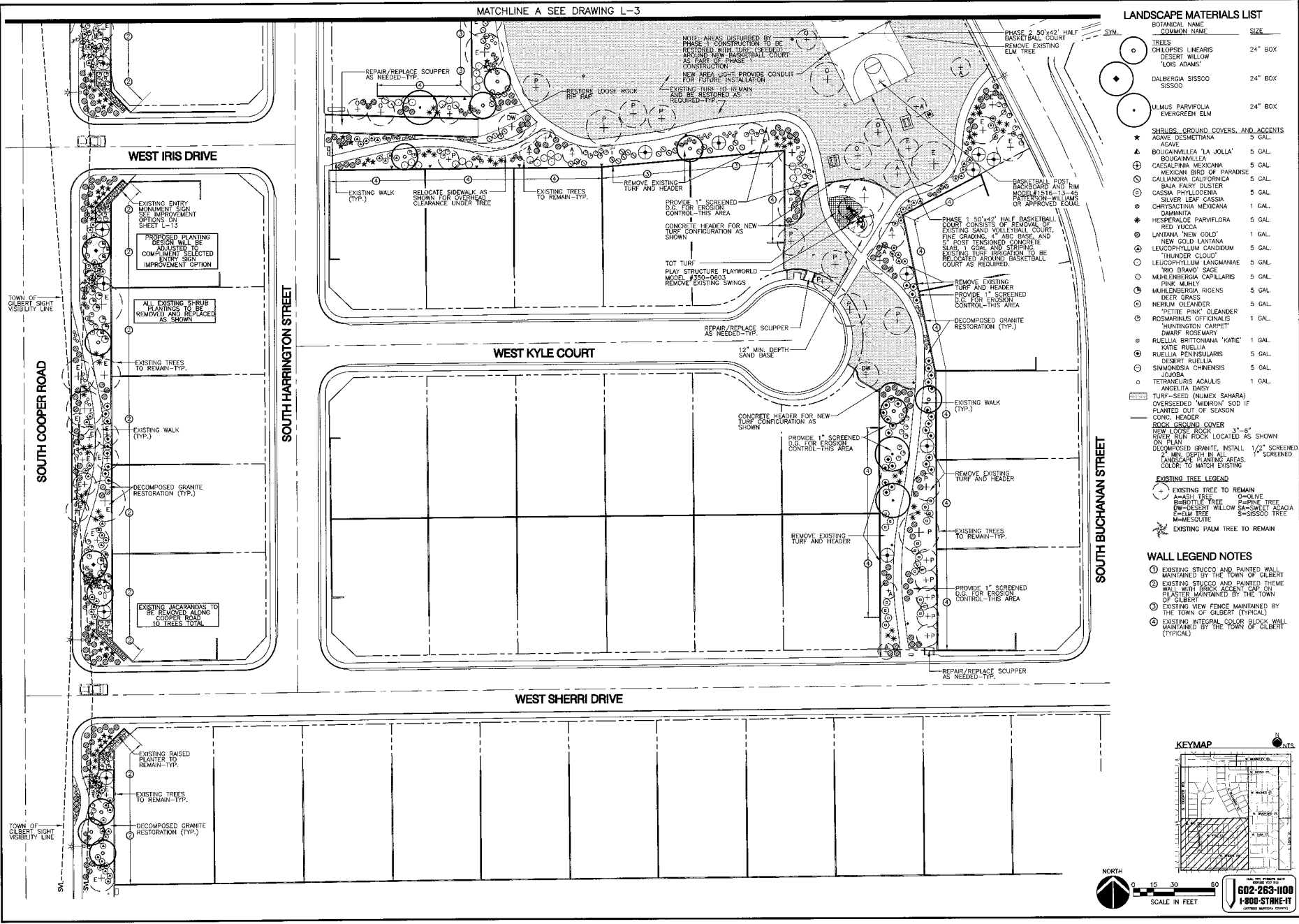

LANDSCAPE MATERIALS LIST

BOTANICAL NAME	COMMON NAME	SIZE
TREES		
CHILIPIS LINEARIS	DESERT WILLOW	24" BOX
LOS ADAMES		
DALBERGIA SISSOO	SISSOO	24" BOX
ULMUS PARVIFOLIA	EVERGREEN ELM	24" BOX
SHRUBS, GROUND COVERS, AND ACCENTS		
AGAVE DESMETIANA		3 GAL.
AGAVE		
BOLIGNIVILLEA "LA JOLLA"		5 GAL.
CAESALPINA MEXICANA	MEXICAN BIRD OF PARADISE	5 GAL.
CALLANDRA CALIFORNICA		5 GAL.
BAJA FAIRY DUSTER		5 GAL.
CASSIA PHYLLOIDENA	SILVER LEAF CASSIA	5 GAL.
CHRISTINA MEXICANA	GAMANTIA	1 GAL.
HESPERALOE PARVIFLORA	RED YUCCA	5 GAL.
LANIANA "NEW GOLD"		1 GAL.
NEW GOLD LANIANA		5 GAL.
LEUCOPHYLLUM CANDIDUM	"THUNDER CLOUD"	5 GAL.
LEUCOPHYLLUM LANGMANIAE	RED BRANDY	5 GAL.
MUHLENBERGIA CAPILLARIS	PINK MILKWEED	5 GAL.
MUHLENBERGIA RIENSIS	DEER GRASS	5 GAL.
NEROLI OLEANDER	"PETITE PINK" OLEANDER	1 GAL.
ROSMARINUS OFFICINALIS	"HUNTINGTON GARRET"	1 GAL.
DWARF ROSEMARY		
RUELLIA BRITTONIANA "KATIE"	KATIE RUELLIA	1 GAL.
RUELLIA PENNSULARIS		5 GAL.
DESERT RUELLIA		5 GAL.
SIMMONDSIA CHINENSIS	YOJOBA	1 GAL.
TETRANEURIS ACALUIS	ANGELITA DAISSY	1 GAL.
TURF-SEED (MIMEX SAMARA)		
OVERSEEDED "MIDROW" SOD IF		
PLANTED OUT OF SEASON		
CONC. HEADER		
ROCK GROUND COVER		
NEW LOOSE ROCK		
RED RUIR ROCK LOCATED AS SHOWN ON PLAN		
DECOMPOSED GRANITE, INSTALL 1/2" SCREENED		
7" MIN. DEPTH IN ALL LANDSCAPE PLANTING AREAS.		
COLOR: TO MATCH EXISTING		

- EXISTING TREE LEGEND**
- + EXISTING TREE TO REMAIN
 - WASH TREE
 - PINE TREE
 - DESERT WILLOW
 - S-SISSOO TREE
 - M-RESOLITE
 - EXISTING PALM TREE TO REMAIN
- WALL LEGEND NOTES**
- ① EXISTING STUCCO AND PAINTED WALL MAINTAINED BY THE TOWN OF GILBERT
 - ② EXISTING STUCCO AND PAINTED THEME WALL WITH BRICK ACCENT CAP ON GLASSER MAINTAINED BY THE TOWN OF GILBERT
 - ③ EXISTING VIEW FENCE MAINTAINED BY THE TOWN OF GILBERT (TYPICAL)
 - ④ EXISTING INTEGRAL COLOR BLOCK WALL MAINTAINED BY THE TOWN OF GILBERT (TYPICAL)

KEYMAP

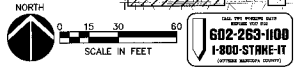
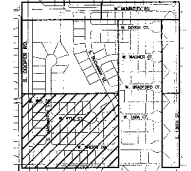

602-263-1100
1-800-STONE-IT

NO.	DATE	DESCRIPTION



McCloskey + Peltz, Inc.
LANDSCAPE ARCHITECTS
One West Elliot Road Suite 110
Tempe, Arizona 85284
Phone: (480) 838-8777
Fax: (480) 831-1774

Landscape Plan
Pathway Improvement District 07-2
TEMPLETON PLACE
PREPARED FOR: Town of Gilbert

DESIGNED BY: MPI
DRAWN BY: BCD
CHECKED BY: DGM
PROJECT NO: 06422
DATE: 1/2008

DRAWING NO.
L-2
SHEET 2 OF 16

MATCHLINE B SEE DRAWING L-4

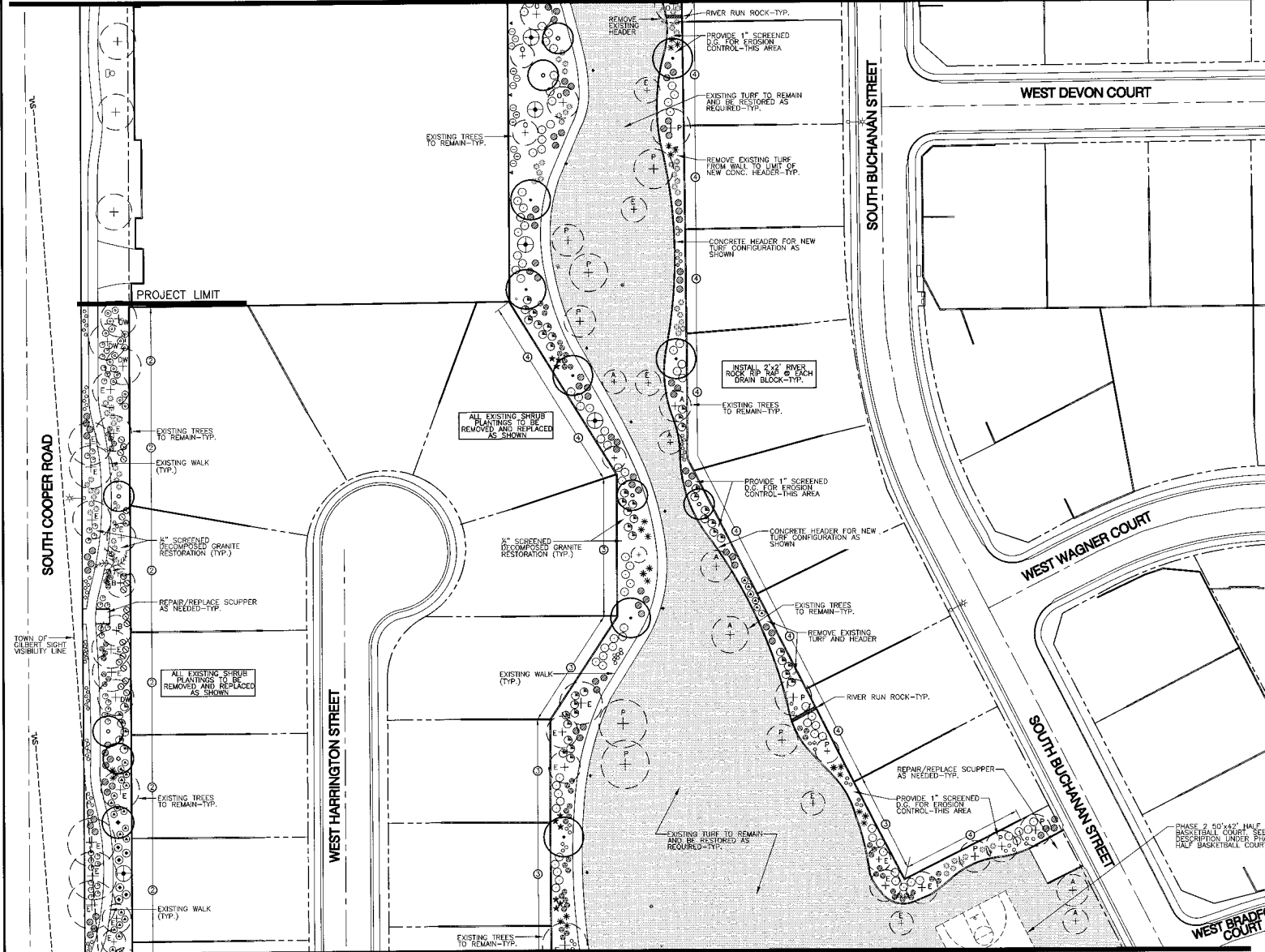

MATCHLINE A SEE DRAWING L-2

LANDSCAPE MATERIALS LIST

SYM.	BOTANICAL NAME COMMON NAME	SIZE
○	TREES	
○	CHILOPSIS LINEARIS DESERT WILLOW 'LOIS ADAMS'	24" BOX
○	DALBERGIA SISSOO SISSOO	24" BOX
○	ULMUS PARVIFLORA EVERGREEN ELM	24" BOX
SHRUBS, GROUND COVERS, AND ACCENTS		
★	AGAVE DESMETIANA	5 GAL.
▲	BOUGAINVILLEA 'LA JOLLA'	5 GAL.
▲	BOUGAINVILLEA	5 GAL.
⊕	CAESALPINIA MEXICANA	5 GAL.
⊕	MEXICAN BIRD OF PARADISE	5 GAL.
⊕	CALLIANDRA CALIFORNICA	5 GAL.
⊕	CASSIA FARY DUSTER	5 GAL.
⊕	CASSIA PHYLODENDRA	5 GAL.
⊕	SILVER LEAF CASSIA	1 GAL.
⊕	CHRYSANTHEMUM MEXICANA DAMIANITA	5 GAL.
★	HESPERALOE PARVIFLORA RED YUCCA	5 GAL.
⊕	LANTANA 'NEW GOLD'	1 GAL.
⊕	NEW GOLD LANTANA	5 GAL.
⊕	LEUCOPHYLLUM CANDIDUM 'THUNDER CLOUD'	5 GAL.
⊕	LEUCOPHYLLUM LANGMANIAE 'RIO BRAVO' SAGE	5 GAL.
⊕	MUHLENBERGIA CAPILLARIS PINK MUHLY	5 GAL.
⊕	MUHLENBERGIA RIGENS	5 GAL.
⊕	NERIUM OLEANDER	5 GAL.
⊕	'PETITE PINK' OLEANDER	1 GAL.
⊕	ROSMARINUS OFFICINALIS 'HUNTINGTON CARPET'	1 GAL.
⊕	DWARF ROSEMARY	1 GAL.
⊕	RUPELLIA BRITTONIANA 'KATIE'	1 GAL.
⊕	KATIE RUPELLIA	5 GAL.
⊕	RUPELLIA PENINSULARIS DESERT RUPELLIA	5 GAL.
⊕	SIMMONDSIA CHINENSIS	5 GAL.
⊕	JUCOSIA	1 GAL.
⊕	TETRAELURIS ACALUIS ANGELITA DASY	5 GAL.
⊕	TURF-SEED (NIMEX SAHARA) OVERSEEDED 'MIDRON' SOO IF PLANTED OUT OF SEASON	1" SCREENED CONC. HEADER
ROCK GROUND COVER		
○	NEW LOOSE ROCK 3"-6"	
○	RIVER RUN ROCK LOCATED AS SHOWN	
○	DECOMPOSED GRANITE, INSTALL 1/2" SCREENED CONC. HEADER	
○	LANDSCAPE PLANTING AREAS, COLOR: TO MATCH EXISTING	

EXISTING TREE LEGEND

⊕	EXISTING TREE TO REMAIN
○	A-KISH TREE
○	B-BOTTLE TREE
○	DW-DESERT WILLOW
○	E-ELM TREE
○	M-MASCOTTE
○	S-SISSOO TREE
○	EXISTING PALM TREE TO REMAIN

- WALL LEGEND NOTES**
- ① EXISTING STUCCO AND PAINTED WALL MAINTAINED BY THE TOWN OF GILBERT
 - ② EXISTING STUCCO AND PAINTED THEME WALL WITH BRICK ACCENT CAP ON PLASTER MAINTAINED BY THE TOWN OF GILBERT
 - ③ EXISTING VIEW FENCE MAINTAINED BY THE TOWN OF GILBERT (TYPICAL)
 - ④ EXISTING INTEGRAL COLOR BLOCK WALL MAINTAINED BY THE TOWN OF GILBERT (TYPICAL)

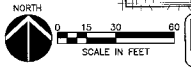
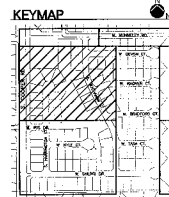

CALL THE TOWN OF GILBERT
602-263-1100
1-800-STRA-11
LANDSCAPE ARCHITECTS

REVISIONS	NO.	DATE	DESCRIPTION



McCloskey + Peltz, Inc.
LANDSCAPE ARCHITECTS
One West Elyot Road Suite 110 Tempe, Arizona 85284
Phone: (480) 848-8777 Fax: (480) 847-7174

Landscape Plan
Parkway Improvement District 07-2
TEMPLETON PLACE
PREPARED FOR: Town of Gilbert

DESIGNED BY: MPI
DRAWN BY: BCD
CHECKED BY: DCM
PROJECT NO: 06422
DATE: 1/2008

DRAWING NO.
L-3
SHEET 3 OF 16

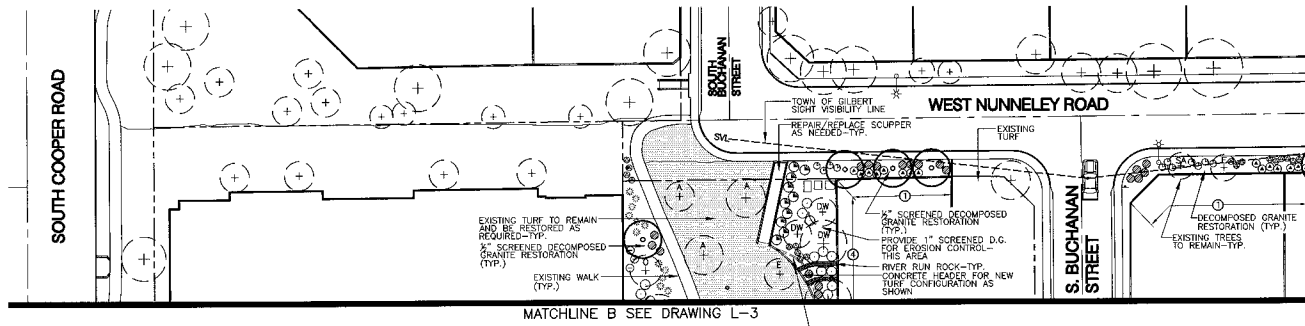

MATCHLINE B SEE DRAWING L-3

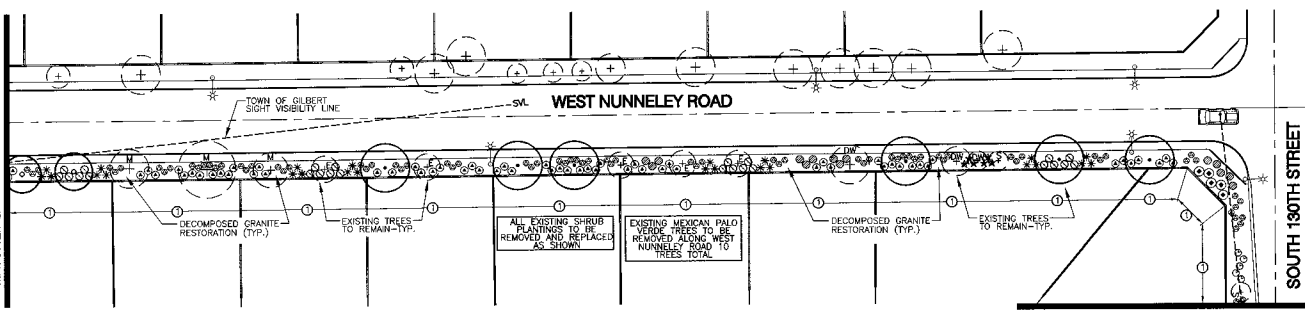

MATCHLINE D SEE DRAWING L-5

LANDSCAPE MATERIALS LIST

SYM.	BOTANICAL NAME COMMON NAME	SIZE
○	TREES	
○	CHILOPSIS LINEARIS	24" BOX
○	DESERT WILLOW	
○	'LOIS ADAMS'	
○	DALBERGA SISSOD	24" BOX
○	SISSOD	
○	ULMUS PARVIFOLIA	24" BOX
○	EVERGREEN ELM	
SHRUBS, GROUND COVERS AND ACCENTS		
★	AGAVE DESMETIANA	5 GAL
▲	AGAVE	
▲	BOUGAINVILLEA 'LA JOLLA'	5 GAL
▲	BOUGAINVILLEA	
⊕	CAESALPINIA MEXICANA	5 GAL
⊕	MEXICAN BIRD OF PARADISE	
⊕	CALLIANDRA CALIFORNICA	5 GAL
⊕	BAJA FAIRY BUSTLE	
⊕	CASSIA PHYLLOENA	5 GAL
⊕	SILVER LEAF CASSIA	
⊕	CHRYSACANTHA MEXICANA	1 GAL
⊕	DAMIANITA	
⊕	HESPERALOE PARVIFLORA	5 GAL
⊕	RED YUCCA	
⊕	LANTANA 'NEW GOLD'	1 GAL
⊕	NEW GOLD LANTANA	
⊕	LEUCOPHYLLUM CANDIDUM	5 GAL
⊕	'THUNDER CLOUD'	
⊕	LEUCOPHYLLUM LANGMANIAE	5 GAL
⊕	'RIO BRAVO' SAGE	
⊕	MULLENBERGIA CAPILLARIS	5 GAL
⊕	PINK MUHLY	
⊕	MULLENBERGIA RIGENS	5 GAL
⊕	DEER GRASS	
⊕	NERIUM OLEANDER	5 GAL
⊕	'PETITE PINK' OLEANDER	
⊕	ROSMARINUS OFFICINALIS	1 GAL
⊕	'HUNTINGTON CARPET'	
⊕	DWARF ROSEMARY	
⊕	RUPELLIA BRITTONIANA 'KATIE'	1 GAL
⊕	KATIE RUPELLIA	
⊕	RUPELLIA PENINSULARIS	5 GAL
⊕	DESERT RUPELLIA	
⊕	SIMMONDISIA CHINENSIS	5 GAL
⊕	JOJOBA	
⊕	TETRANEURIS ACAULIS	1 GAL
⊕	ANGELITA DAISY	
⊕	TURF-SEED (NUMEX SAHARA)	
⊕	OVERSEEDED 'MIDRON' SOID IF PLANTED OUT OF SEASON	
⊕	COND. HEADER	
⊕	ROCK GROUND COVER	
⊕	ANGELITA DAISY	
⊕	NEW LUM ROCK LOCATED AS SHOWN ON PLAN	
⊕	DECOMPOSED GRANITE, INSTALL 1/2" SCREENED 2" MIN. DEPTH IN ALL LANDSCAPE PLANTING AREAS. COLOR TO MATCH EXISTING.	
⊕	DECOMPOSED GRANITE, RESTORATION (TYP.)	
⊕	PROVIDE 1" SCREENED D.G. FOR EROSION CONTROL- THIS AREA	
⊕	RIVER RUN ROCK-TYP	
⊕	CONCRETE HEADER FOR NEW TURF CONFIGURATION AS SHOWN	
⊕	REMOVE EXISTING HEADER	

EXISTING TREE LEGEND

○ EXISTING TREE TO REMAIN
 ○ A-SH TREE
 ○ BOTTLE TREE
 ○ C-ELM TREE
 ○ M-MESQUITE

○ OLIVE
 ○ PINNAC TREE
 ○ S-SWEET ACACIA
 ○ S-SISSOD TREE

WALL LEGEND NOTES

① EXISTING STUCCO AND PAINTED WALL MAINTAINED BY THE TOWN OF GILBERT

② EXISTING STUCCO AND PAINTED THEME WALL WITH BRICK ACCENT CAP ON PLASTER MAINTAINED BY THE TOWN OF GILBERT

③ EXISTING VIEW FENCE MAINTAINED BY THE TOWN OF GILBERT (TYPICAL)

④ EXISTING INTEGRAL COLOR BLOCK WALL MAINTAINED BY THE TOWN OF GILBERT (TYPICAL)

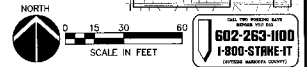
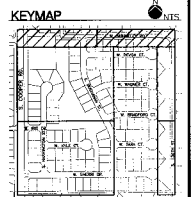

602-263-1100
 1-800-STRE-IT
 LANDSCAPE ARCHITECTS

NO.	DATE	DESCRIPTION



McCloskey + Peltz, Inc.
 LANDSCAPE ARCHITECTS
 One West Elliot Street Suite 110
 Tempe, Arizona 85281
 Phone: (480) 967-9774
 Fax: (480) 967-9774

Landscape Plan
 Parkway Improvement District 07-2
TEMPLETON PLACE
 PREPARED FOR: Town of Gilbert

DESIGNED BY: NPI
 DRAWN BY: BCD
 CHECKED BY: DCM
 PROJECT NO: 06422
 DATE: 1/2008

DRAWING NO.
L-4
 SHEET 4 OF 16

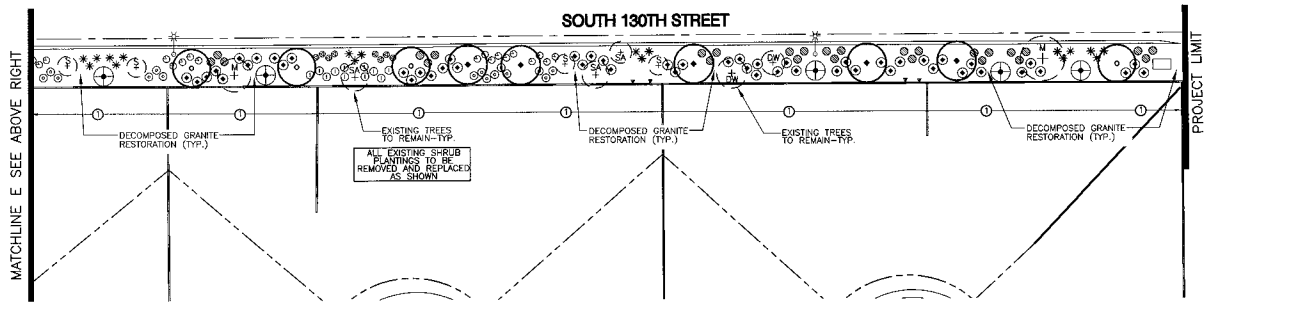
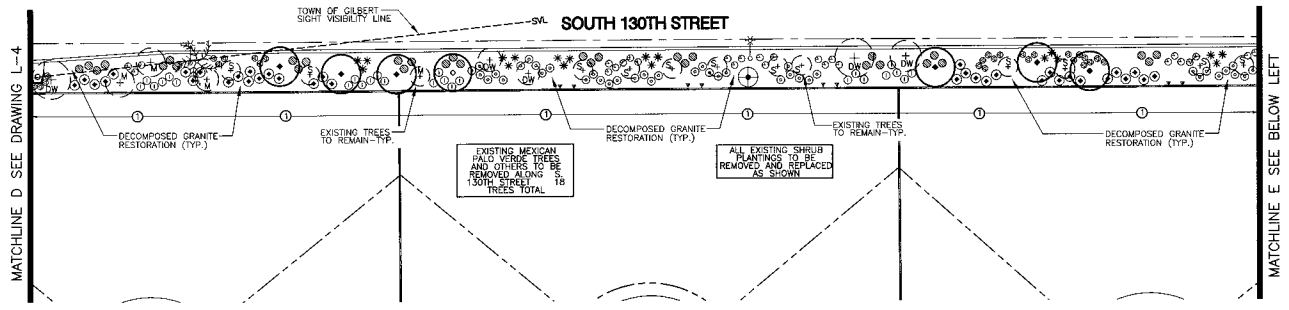

LANDSCAPE MATERIALS LIST

SYM.	BOTANICAL NAME COMMON NAME	SIZE
TREES		
○	CHILOPSIS LINEARIS DESERT WILLOW	24" BOX
◆	LIQS ADAMS	24" BOX
○	DALBERGIA SISSOO SISSOO	24" BOX
○	ULMUS PARVIFOLIA EVERGREEN ELM	24" BOX
SHRUBS, GROUND COVERS, AND ACCENTS		
★	AGAVE DESMETIANA AGAVE	5 GAL.
▲	BOUGAINVILLEA 'LA JOLLA' BOUGAINVILLEA	5 GAL.
⊕	ORSALEPINA MEXICANA MEXICAN BIRD OF PARADISE	5 GAL.
⊙	GALLIARDIA CALIFORNICA BAJA FAIRY DUSTER	5 GAL.
⊕	CASSIA PHYLLODENDIA SILVER LEAF CASSIA	5 GAL.
⊕	CHRYSACTINIA MEXICANA DAMAZINT	1 GAL.
★	HESTERALOE PARVIFLORA RED 'YUCCA'	5 GAL.
⊕	LANTANA 'NEW GOLD' NEW GOLD LANTANA	1 GAL.
⊕	LEUCOPHYLLUM CANDIDUM 'HUNTER GLODY'	5 GAL.
⊕	LEUCOPHYLLUM LANDMANIAE 'RIO BRAVO' SAGE	5 GAL.
⊕	MUHLENBERGIA CAPILLARIS PINK MUHLY	5 GAL.
⊕	MUHLENBERGIA RIGENS DEER GRASS	5 GAL.
⊕	NERIUM OLEANDER 'PETITE PINK' OLEANDER	5 GAL.
⊕	ROSMARINUS OFFICINALIS 'HUNTINGTON CARPET' DWARF ROSEMARY	1 GAL.
⊕	RUELLIA BRITTONIANA 'KATIE' KATIE RUELLIA	1 GAL.
⊕	RUELLIA PENNSULARIS DESERT RUELLIA	5 GAL.
⊕	SIAMONDISA CHINENSIS JOJOBA	5 GAL.
⊕	TETRANEURIS ADALUIS ANGELITA DASY	1 GAL.
■	TURF-SEED (NUMEX SAHARA) OVERSEEDED 'MIDWINTER' SOG IF PLANTED OUT OF SEASON	
—	CONC. HEADER	
■	ROCK GROUND COVER NEW LOOSE ROCK 2"-6" PIPER RUN IN ROCK LOCATED AS SHOWN ON PLAN	
■	DECOMPOSED GRANITE, INSTALL 2" MIN. DEPTH IN ALL LANDSCAPE PLANNING AREAS. COLOR TO MATCH EXISTING	1/2" SCREENED

- #### EXISTING TREE LEGEND
- EXISTING TREE TO REMAIN
 - WASH TREE
 - BUTTLE TREE
 - DW-DESERT WILLOW
 - ELM TREE
 - M-MESQUITE
 - EXISTING PALM TREE TO REMAIN
 - OLIVE
 - P-PINNE TREE
 - SA-SWEET ACACIA
 - S-SISSOO TREE

- #### WALL LEGEND NOTES
- EXISTING STUCCO AND PAINTED WALL MAINTAINED BY THE TOWN OF GILBERT
 - EXISTING STUCCO AND PAINTED THEME WALL WITH BRICK ACCENT CAP ON GRATES MAINTAINED BY THE TOWN OF GILBERT
 - EXISTING VIEW FENCE MAINTAINED BY THE TOWN OF GILBERT (TYPICAL)
 - EXISTING INTEGRAL COLOR BLOCK WALL MAINTAINED BY THE TOWN OF GILBERT (TYPICAL)

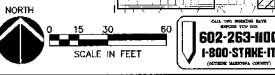
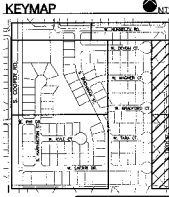

REVISIONS	NO.	DATE	DESCRIPTION



McCloskey • Peltz, Inc.
LANDSCAPE ARCHITECTS
 10000 S. Baseline Rd., Suite 110
 Phoenix, AZ 85048
 Phone: (602) 958-9777
 Fax: (602) 958-9774

Landscape Plan
 Parkway Improvement District 07-2
TEMPLETON PLACE
 PREPARED FOR: Town of Gilbert

DESIGNED BY: MPI
DRAWN BY: BCD
CHECKED BY: DCM
PROJECT NO: 06422
DATE: 1/2008

DRAWING NO:
L-5
 SHEET 5 OF 16

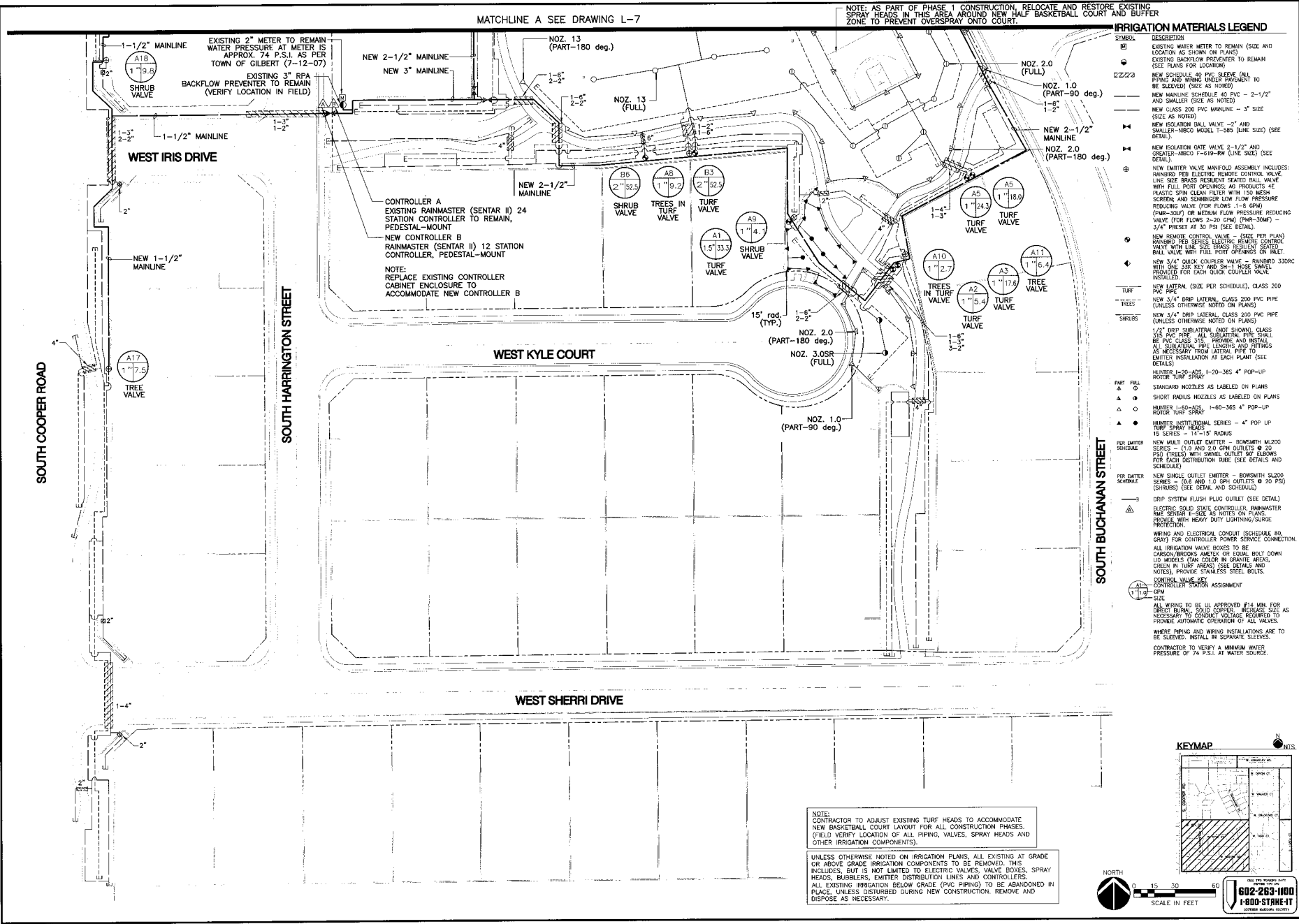

REVISIONS	NO.	DATE	DESCRIPTION



McCloskey • Peltz, Inc.
LANDSCAPE ARCHITECTS
100 West Elbow Street, Suite 110
Tempe, Arizona 85283
Phone: 480.966.8777
Fax: 480.966.9176

Irriation Plan
Parkway Improvement District 07-2
TEMPLETON PLACE
PREPARED FOR: **Town of Gilbert**

DESIGNED BY: **MPJ**
DRAWN BY: **BCD**
CHECKED BY: **DCM**
PROJECT NO: **06422**
DATE: **1/2008**

DRAWING NO.
L-6
SHEET **6** OF **16**

602-263-1100
1-800-STR-HE-IT
© 2008 STR-HE-IT

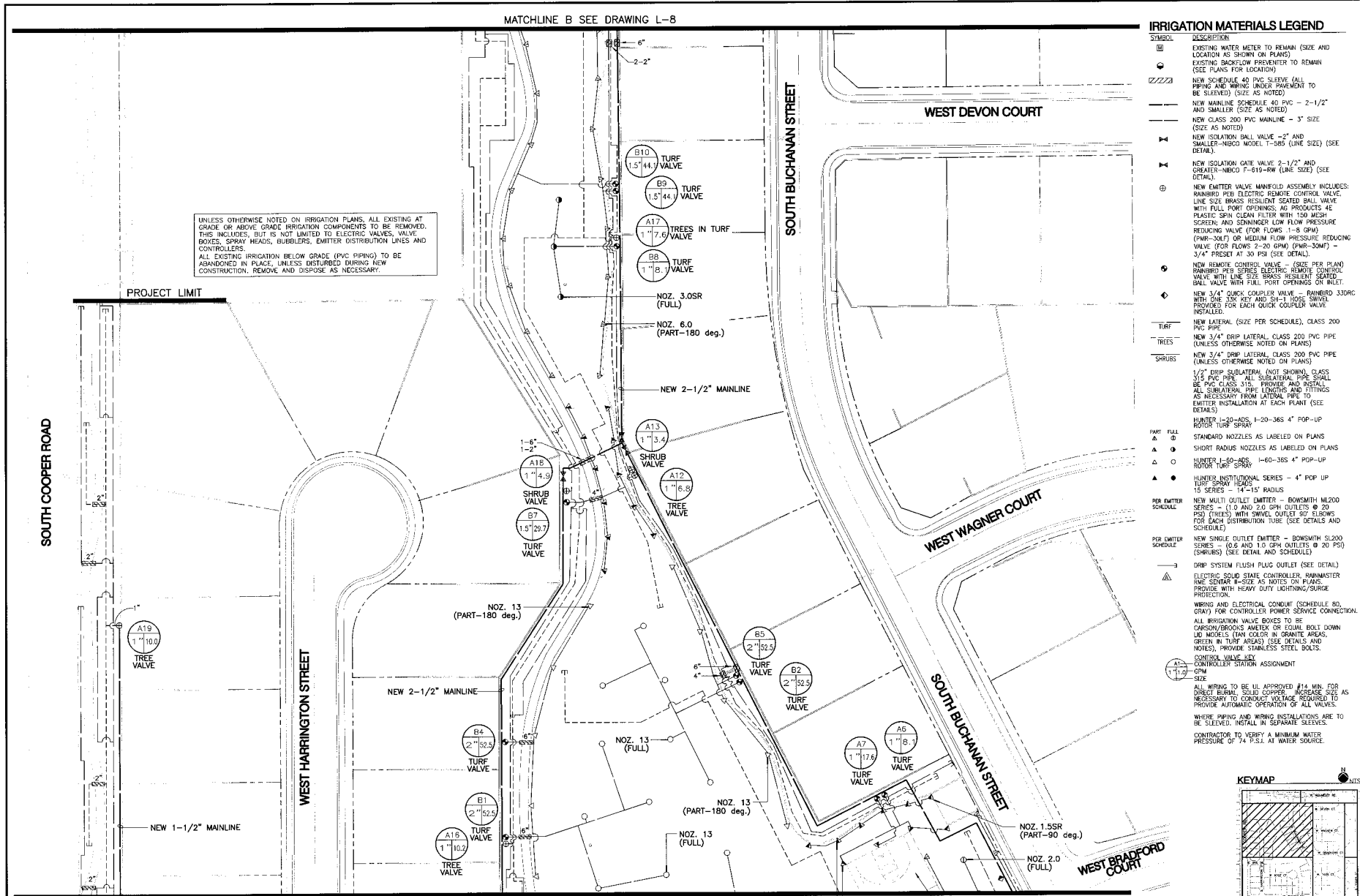

UNLESS OTHERWISE NOTED ON IRRIGATION PLANS, ALL EXISTING AT GRADE OR ABOVE GRADE IRRIGATION COMPONENTS TO BE REMOVED. THIS INCLUDES, BUT IS NOT LIMITED TO, ELECTRIC VALVES, VALVE BOXES, SPRAY HEADS, BUBBLERS, EMITTER DISTRIBUTION LINES AND CONTROLLERS. ALL EXISTING IRRIGATION BELOW GRADE (PVC PIPING) TO BE ABANDONED IN PLACE, UNLESS DISTURBED DURING NEW CONSTRUCTION, REMOVE AND DISPOSE AS NECESSARY.

MATCHLINE B SEE DRAWING L-8

MATCHLINE A SEE DRAWING L-6

NOTE: CONTRACTOR TO ADJUST EXISTING TURF HEADS TO ACCOMMODATE NEW BASKETBALL COURT LAYOUT FOR ALL CONSTRUCTION PHASES. (FIELD VERIFY LOCATION OF ALL PIPING, VALVES, SPRAY HEADS AND OTHER IRRIGATION COMPONENTS).

NOTE: AS PART OF PHASE 2 CONSTRUCTION, RELOCATE AND RESTORE EXISTING SPRAY HEADS IN THIS AREA AROUND NEW BASKETBALL COURT AND BUFFER ZONE TO PREVENT OVERSPRAY ONTO COURT.

IRRIGATION MATERIALS LEGEND

- | SYMBOL | DESCRIPTION |
|--------|--|
| | EXISTING WATER METER TO REMAIN (SIZE AND LOCATION AS SHOWN ON PLANS) |
| | EXISTING BACKFLOW PREVENTER TO REMAIN (SEE PLANS FOR LOCATION) |
| | NEW SCHEDULE 40 PVC SLEEVE (ALL PIPING AND WIRING UNDER PREMENT TO BE SLEEVED) (SIZE AS NOTED) |
| | NEW MAINLINE SCHEDULE 40 PVC - 2-1/2" AND SMALLER (SIZE AS NOTED) |
| | NEW CLASS 200 PVC MAINLINE - 3" SIZE (SIZE AS NOTED) |
| | NEW ISOLATION BALL VALVE - 2" AND SMALLER-NIBCO MODEL T-385 (LINE SIZE) (SEE DETAIL) |
| | NEW ISOLATION GATE VALVE 2-1/2" AND GREATER-NIBCO F-619-RW (LINE SIZE) (SEE DETAIL) |
| | NEW EMITTER VALVE MANIFOLD ASSEMBLY INCLUDES: RAINBIRD PER ELECTRIC REMOTE CONTROL VALVE, LINE SIZE BRASS RESILIENT SEATED BALL VALVE WITH FULL PORT OPENING; 4G PRODUCTS 4E PLASTIC SPIN CLEAN FILTER WITH 150 MESH SCREEN; AND SENNINGER LOW FLOW PRESSURE REDUCING VALVE (FOR FLOWS 1-8 GPM) (PWR-30M7) OR MEDIUM FLOW PRESSURE REDUCING VALVE (FOR FLOWS 2-20 GPM) (PWR-30M7) - 3/4" PRESET AT 30 PSI (SEE DETAIL) |
| | NEW REMOTE CONTROL VALVE - (SIZE PER PLAN) RAINBIRD PER ELECTRIC REMOTE CONTROL VALVE WITH LINE SIZE BRASS RESILIENT SEATED BALL VALVE WITH FULL PORT OPENING ON INLET. |
| | NEW 3/4" QUICK COUPLER VALVE - RAINBIRD 330RC WITH ONE 3/8" KEY AND SH-CL HOSE SWIVEL FOR EACH QUICK COUPLER VALVE INSTALLED. |
| | NEW LATERAL (SIZE PER SCHEDULE), CLASS 200 PVC PIPE |
| | NEW 3/4" DRIP LATERAL, CLASS 200 PVC PIPE (UNLESS OTHERWISE NOTED ON PLANS) |
| | NEW 3/4" DRIP LATERAL, CLASS 200 PVC PIPE (UNLESS OTHERWISE NOTED ON PLANS) |
| | 1/2" DRIP SUBLATERAL (NOT SHOWN), CLASS 315 PVC PIPE. ALL SUBLATERAL PIPES SHALL BE PVC CLASS 315. PROVIDE AND INSTALL ALL SUBLATERAL PIPE JOINTS AND FITTINGS AS NECESSARY FROM LATERAL PIPE TO EMITTER INSTALLATION AT EACH PLANT (SEE DETAIL) |
| | HUNTER I-30-ADS, I-20-36S 4" POP-UP ROTOR TURF SPRAY |
| | STANDARD NOZZLES AS LABELED ON PLANS |
| | SHORT RADIUS NOZZLES AS LABELED ON PLANS |
| | HUNTER I-60-ADS, I-60-36S 4" POP-UP ROTOR TURF SPRAY |
| | HUNTER INSTITUTIONAL SERIES - 4" POP UP 15 SERIES - 14'-15" RADIUS |
| | NEW MULTI OUTLET EMITTER - BOWSMITH M200 SERIES - (1.0 AND 2.0 GPM OUTLETS @ 20 PSI) (TREES) WITH SWIVEL OUTLET 90° ELBOWS FOR EACH DISTRIBUTION TUBE (SEE DETAILS AND SCHEDULE) |
| | NEW SINGLE OUTLET EMITTER - BOWSMITH S200 SERIES - (0.6 AND 1.0 GPM OUTLETS @ 20 PSI) (SHRUBS) (SEE DETAIL AND SCHEDULE) |
| | DRIP SYSTEM FLUSH PLUG OUTLET (SEE DETAIL) |
| | ELECTRIC SOLID STATE CONTROLLER, RAINMASTER RWE SENSAR II-SIZE AS NOTES ON PLANS. PROVIDE WITH HEAVY DUTY LIGHTNING/SURGE PROTECTION. |
| | WIRING AND ELECTRICAL CONDUIT (SCHEDULE 80 GRAY) FOR CONTROLLER POWER SERVICE CONNECTION. |
| | ALL IRRIGATION VALVE BOXES TO BE CARSON/BROOKS AMETEK OR EQUAL BOLD DOWN LID MODELS (TAN COLOR IN GRANITE AREAS, GREEN IN TURF AREAS) (SEE DETAILS AND NOTES), PROVIDE STAINLESS STEEL BOLTS. |
| | CONTROL VALVE KEY |
| | CONTROL STATION ASSIGNMENT |
| | 0-1/4" SIZE |
| | ALL WIRING TO BE UL APPROVED #14 MN. FOR DIRECT BURIAL, SOLID COPPER. INCREASE SIZE AS NECESSARY TO CONDUCT VOLTAGE REQUIRED TO PROVIDE AUTOMATIC OPERATION OF ALL VALVES. |
| | WHERE PIPING AND WIRING INSTALLATIONS ARE TO BE SLEEVED, INSTALL IN SEPARATE SLEEVES. |
| | CONTRACTOR TO VERIFY A MINIMUM WATER PRESSURE OF 74 P.S.I. AT WATER SOURCE. |

KEYMAP

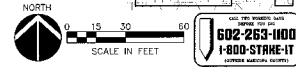
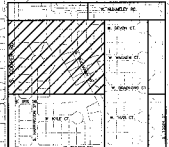

NO.	DATE	DESCRIPTION



McCloskey + Peitz, Inc.
 LANDSCAPE ARCHITECTS
 One West Elliot Road Suite 110
 Tempe, Arizona 85284
 Phone: (602) 338-8777
 Fax: (602) 811-1774

Irrigation Plan
 Parkway Improvement District 07-2
TEMPLETON PLACE
 PREPARED FOR: Town of Gilbert

DESIGNED BY: MPI
 DRAWN BY: BCD
 CHECKED BY: DCM
 PROJECT NO: 06422
 DATE: 1/2008

DRAWING NO.
L-7
 SHEET 7 OF 16

602-263-1100
 1-800-STRE-11
 LANDSCAPE ARCHITECTS

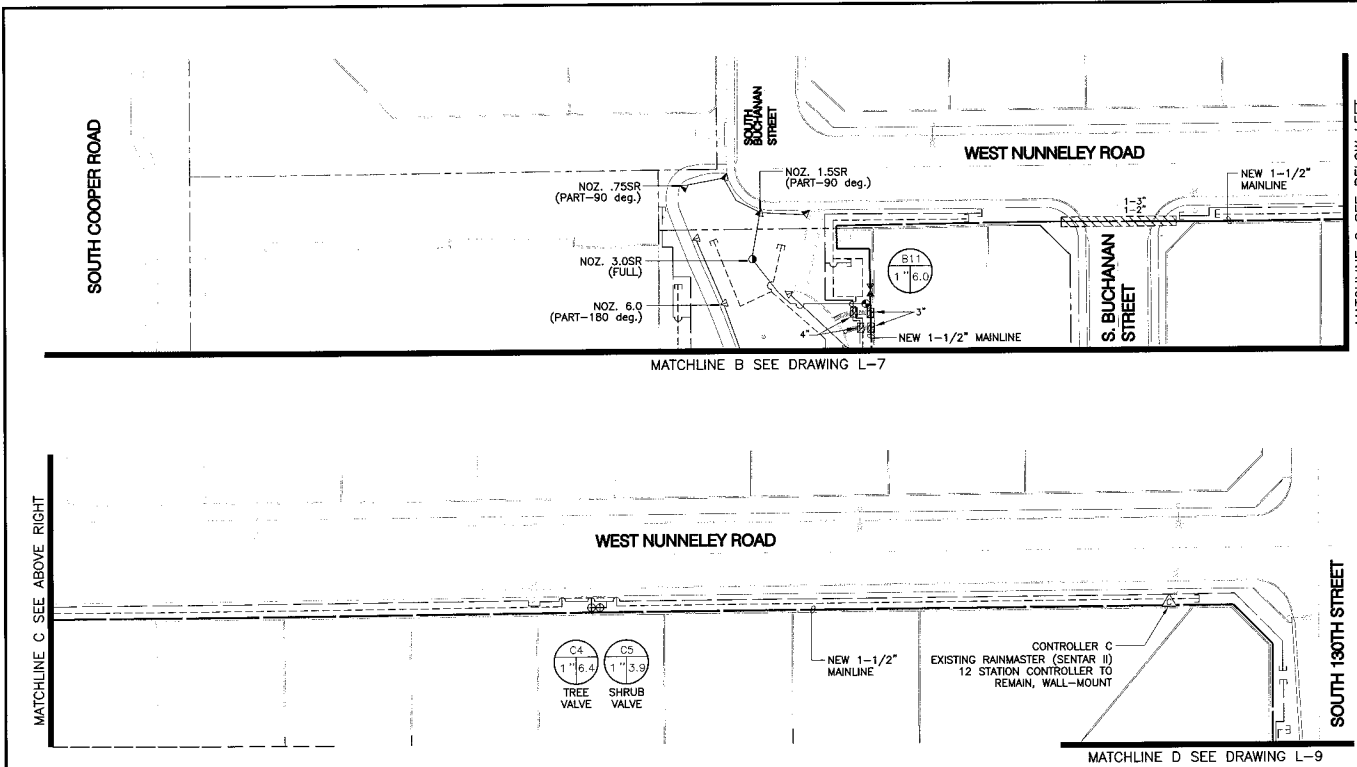

IRRIGATION MATERIALS LEGEND

- | SYMBOL | DESCRIPTION |
|--------|--|
| (M) | EXISTING WATER METER TO REMAIN (SIZE AND LOCATION AS SHOWN ON PLANS) |
| (B) | EXISTING BACKFLOW PREVENTER TO REMAIN (SEE PLANS FOR LOCATION) |
| (N) | NEW SCHEDULE 40 PVC SLEEVE (ALL PIPING AND WIRING UNDER PAVEMENT TO BE SLEEVED) (SIZE AS NOTED) |
| (M) | NEW MAINLINE SCHEDULE 40 PVC - 2-1/2" AND SMALLER (SIZE AS NOTED) |
| (M) | NEW CLASS 200 PVC MAINLINE - 3" SIZE (SIZE AS NOTED) |
| (M) | NEW SOLAR BALL VALVE - 2" AND SMALLER-NIBCO MODEL T-585 (LINE SIZE) (SEE DETAIL) |
| (M) | NEW ISOLATION GATE VALVE 2-1/2" AND GREATER-NIBCO F-619-RW (LINE SIZE) (SEE DETAIL) |
| (M) | NEW EMITTER VALVE MANIFOLD ASSEMBLY INCLUDES: RAINBIRD PER SERIES ELECTRIC REMOTE CONTROL VALVE LINE SIZE BRASS RESILIENT SEATED BALL VALVE WITH FULL PORT OPENINGS; 40 PRODUCTS HE PLASTIC SPIN CLEAN FILTER WITH 150 MESH SCREEN; AND SENNINGER LOW FLOW PRESSURE REDUCING VALVE (FOR FLOWS 1-8 GPM) (PMR-30L) OR MEDIUM FLOW PRESSURE REDUCING VALVE (FOR FLOWS 2-20 GPM) (PMR-30M) - 3/4" PRESSET AT 30 PSI (SEE DETAIL) |
| (M) | NEW REMOTE CONTROL VALVE - (SIZE PER PLAN) RAINBIRD PER SERIES ELECTRIC REMOTE CONTROL VALVE WITH LINE SIZE BRASS RESILIENT SEATED BALL VALVE WITH FULL PORT OPENINGS ON INLET |
| (M) | NEW 3/4" QUICK COUPLER VALVE - RAINBIRD 330RC WITH ONE 3/8" KEY AND SH-1 HOSE SWIVEL PROVIDED FOR EACH QUICK COUPLER VALVE INSTALLED |
| (M) | NEW LATERAL (SIZE PER SCHEDULE), CLASS 200 PVC PIPE |
| (M) | NEW 3/4" DRIP LATERAL CLASS 200 PVC PIPE (UNLESS OTHERWISE NOTED ON PLANS) |
| (M) | NEW 3/4" DRIP LATERAL CLASS 200 PVC PIPE (UNLESS OTHERWISE NOTED ON PLANS) |
| (M) | 1/2" DRIP SUBLATERAL (NOT SHOWN) CLASS 1/2" PVC PIPE - ALL SUBLATERAL PIPE SHALL BE PVC CLASS 115. PROVIDE AND INSTALL ALL SUBLATERAL PIPE LENGTHS AND FITTINGS AS NECESSARY FROM LATERAL PIPE TO EMITTER INSTALLATION AT EACH PLANT (SEE DETAILS) |
| (M) | HUNTER 1-60-ADS, 1-20-36S 4" POP-UP ROTOR TURF SPRAY |
| (M) | STANDARD NOZZLES AS LABELED ON PLANS |
| (M) | SHORT RADIUS NOZZLES AS LABELED ON PLANS |
| (M) | HUNTER 1-60-ADS, 1-60-36S 4" POP-UP ROTOR TURF SPRAY |
| (M) | HUNTER INSTITUTIONAL SERIES - 4" POP UP TURF SPRAY HEADS |
| (M) | 15 SERIES - 14'-15" RADIUS |
| (M) | NEW MULTI OUTLET EMITTER - BOWSMITH M2000 SERIES - (1.0 AND 2.0 GPH OUTLETS @ 20 PSI) (TREES) WITH SWIVEL OUTLET SET SCREWS FOR EACH DISTRIBUTION TUBE (SEE DETAILS AND SCHEDULE) |
| (M) | NEW SINGLE OUTLET EMITTER - BOWSMITH S2000 SERIES - (0.8 AND 1.0 GPH OUTLETS @ 20 PSI) (SHRUBS) (SEE DETAIL AND SCHEDULE) |
| (M) | DRIP SYSTEM FLUSH PLUG OUTLET (SEE DETAIL) |
| (M) | ELECTRIC SOLID STATE CONTROLLER, RAINMASTER RMC SENTAR II-SIZE AS NOTED ON PLANS. PROVIDE WITH HEAVY DUTY LIGHTNING/SURGE PROTECTION. |
| (M) | WIRING AND ELECTRICAL CONDUIT (SCHEDULE 80, GRAY) FOR CONTROLLER POWER SERVICE CONNECTION. |
| (M) | ALL IRRIGATION VALVE BOXES TO BE CARBON/BRONZE ANCHER OR EQUAL BOLT DOWN LID MODELS (TAN COLOR IN GRANITE AREAS, GREEN IN TURF AREAS) (SEE DETAILS AND NOTES). PROVIDE STAINLESS STEEL BOLTS. |
| (M) | CONTROL VALVE KEY
CONTROLLER STATION ASSIGNMENT |
| (M) | SIZE
ALL WIRING TO BE UL APPROVED #14 MIN FOR DIRECT BURIAL, SOLID COPPER. INCREASE SIZE AS NECESSARY TO CONDUCT VOLTAGE REQUIRED TO PROVIDE AUTOMATIC OPERATION OF ALL VALVES. |
| (M) | WHERE PIPING AND WIRING INSTALLATIONS ARE TO BE SLEEVED, INSTALL IN SEPARATE SLEEVES. |
| (M) | CONTRACTOR TO VERIFY A MINIMUM WATER PRESSURE OF 74 P.S.I. AT WATER SOURCE. |

REVISIONS	NO.	DATE	DESCRIPTION



McCloskey + Peltz, Inc.
 LANDSCAPE ARCHITECTS
 One West Elster Road Suite 110 Tempe, Arizona 85281
 Phone: (480) 304-7177 Fax: (480) 304-7174

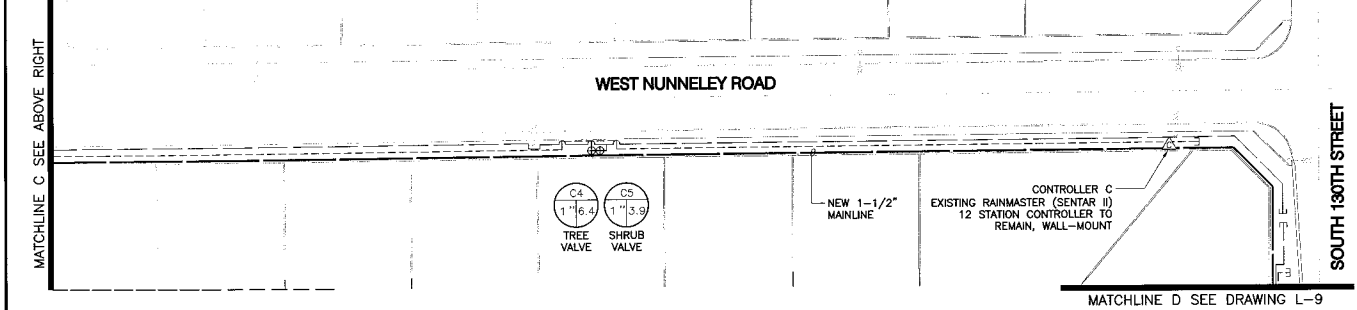

UNLESS OTHERWISE NOTED ON IRRIGATION PLANS, ALL EXISTING AT GRADE OR ABOVE GRADE IRRIGATION COMPONENTS TO BE REMOVED. THIS INCLUDES, BUT IS NOT LIMITED TO, ELECTRIC VALVES, VALVE BOXES, SPRAY HEADS, BUBBLERS, EMITTER DISTRIBUTION LINES AND CONTROLLERS.
 ALL EXISTING IRRIGATION BELOW GRADE (PVC PIPING) TO BE ABANDONED IN PLACE, UNLESS DISTURBED DURING NEW CONSTRUCTION. REMOVE AND DISPOSE AS NECESSARY.

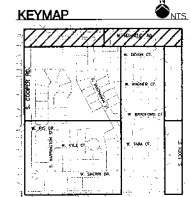
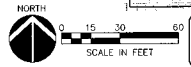

602-263-1100
 1-800-STRAKE-IT

Irrigation Plan
 Parkway Improvement District 07-2
TEMPLETON PLACE
 PREPARED FOR: Town of Gilbert

DESIGNED BY: MPI
 DRAWN BY: BCD
 CHECKED BY: DCM
 PROJECT NO: 06422
 DATE: 1/2008

DRAWING NO.
L-8
 SHEET 8 OF 16

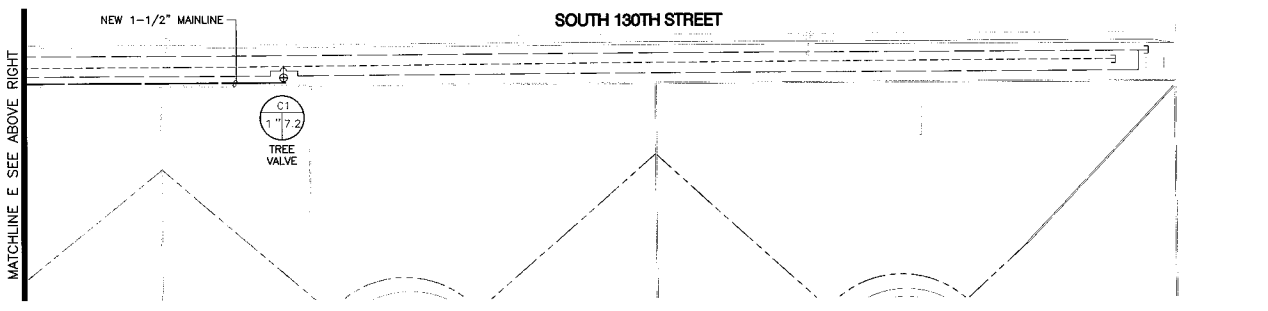
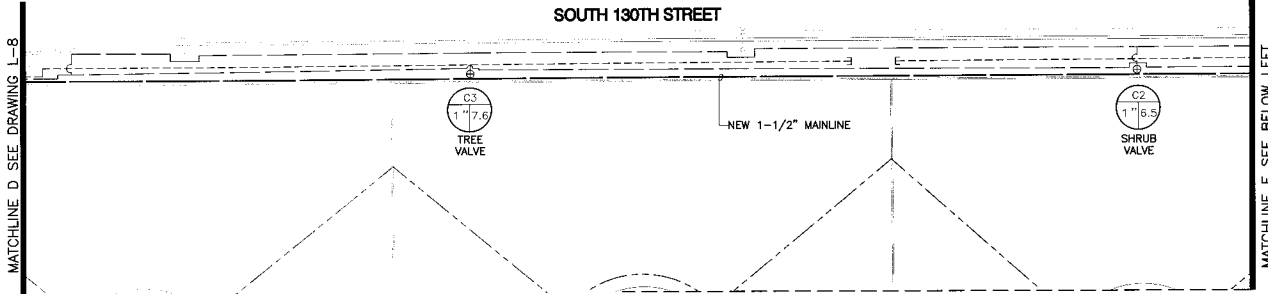

IRRIGATION MATERIALS LEGEND

- | SYMBOL | DESCRIPTION |
|--------|--|
| | EXISTING WATER METER TO REMAIN (SIZE AND LOCATION AS SHOWN ON PLANS) |
| | EXISTING BACKFLOW PREVENTER TO REMAIN (SEE PLANS FOR LOCATION) |
| | NEW SCHEDULE 40 PVC SLEEVE (ALL PIPING AND WIRING UNDER PLANTING TO BE SLEEVED) (SIZE AS NOTED) |
| | NEW MAINLINE SCHEDULE 40 PVC - 2-1/2" AND SMALLER (SIZE AS NOTED) |
| | NEW CLASS 200 PVC MAINLINE - 3" SIZE (SIZE AS NOTED) |
| | NEW ISOLATION BALL VALVE - 2" AND SMALLER-NECO MODEL 1-360 (LINE SIZE) (SEE DETAIL) |
| | NEW ISOLATION GATE VALVE 2-1/2" AND GREATER-NECO F-619-RW (LINE SIZE) (SEE DETAIL) |
| | NEW EMITTER VALVE MANIFOLD ASSEMBLY INCLUDES: RAINBIRD P&B ELECTRIC REMOTE CONTROL VALVE, LINE SIZE BRASS RESILIENT SEALED BALL VALVE WITH FULL PORT OPENINGS; AG PRODUCTS 4E PLASTIC SPIN CLEAN FILTER WITH 150 MESH SCREEN; AND SENNIKER LOW FLOW PRESSURE REDUCING VALVE (FOR FLOWS 1-8 GPM) (PWR-30L7) OR MEDIUM FLOW PRESSURE REDUCING VALVE (FOR FLOWS 2-20 GPM) (PWR-30M) - 3/4" PRESET AT 30 PSI (SEE DETAIL). |
| | NEW REMOTE CONTROL VALVE - (SEE PER PLAN) |
| | RAINBIRD P&B SERIES ELECTRIC REMOTE CONTROL VALVE WITH LINE SIZE BRASS RESILIENT SEALED BALL VALVE WITH FULL PORT OPENINGS ON INLET. |
| | NEW 3/4" QUICK COUPLER VALVE - RAINBIRD 330RC WITH ONE KEY AND 1/2" HOSE SWIVEL PROVIDED FOR EACH QUICK COUPLER VALVE INSTALLED. |
| | NEW LATERAL (SIZE PER SCHEDULE), CLASS 200 PVC PIPE |
| | NEW 3/4" DRIP LATERAL, CLASS 200 PVC PIPE (UNLESS OTHERWISE NOTED ON PLANS) |
| | NEW 3/4" DRIP LATERAL, CLASS 200 PVC PIPE (UNLESS OTHERWISE NOTED ON PLANS) |
| | 1/2" DRIP SUBLATERAL (NOT SHOWN), CLASS 315 PVC PIPE - ALL SUBLATERAL PIPE SHALL BE PVC CLASS 315 - PROVIDE AND INSTALL ALL SUBLATERAL PIPE JOINTS AND FITTINGS AS NECESSARY FROM LATERAL PIPE TO EMITTER INSTALLATION AT EACH PLANT (SEE DETAILS) |
| | HUNTER 1-20-ADS, 1-20-3ES 4" POP-UP ROTOR TURF SPRAY |
| | STANDARD NOZZLES AS LABELED ON PLANS |
| | SHORT RADIUS NOZZLES AS LABELED ON PLANS |
| | HUNTER 1-60-ADS, 1-60-3ES 4" POP-UP ROTOR TURF SPRAY |
| | HUNTER INSTITUTIONAL SERIES - 4" POP UP TURF SPRAY HEADS |
| | 15 SERIES - 14-15' RADIUS |
| | NEW MULTI OUTLET EMITTER - BOWSMITH M200 SERIES - (1.0 AND 2.0 GPH OUTLETS @ 20 PSI) (TREES) WITH SWIVEL OUTLET 90° ELBOWS FOR EACH DISTRIBUTION TUBE (SEE DETAILS AND SCHEDULE) |
| | NEW SINGLE OUTLET EMITTER - BOWSMITH SL200 SERIES - (0.8 AND 1.0 GPH OUTLETS @ 20 PSI) (SHRUBS) (SEE DETAIL AND SCHEDULE) |
| | DRIP SYSTEM FLUSH PLUG OUTLET (SEE DETAIL) |
| | ELECTRIC SOLID STATE CONTROLLER, RAINMASTER RMC SENIAR II-SIZE AS NOTES ON PLANS. PROVIDE WITH HEAVY DUTY LIGHTNING SURGE PROTECTION. |
| | WIRING AND ELECTRICAL CONDUIT (SCHEDULE 80, GRAY) FOR CONTROLLER POWER SERVICE CONNECTION. |
| | ALL IRRIGATION VALVE BOXES TO BE CARSON/BROOKS AMETEX OR EQUAL, BOLT DOWN LID MODELS (PINK COLOR IN ORNATE AREAS, GREEN IN TURF AREAS) (SEE DETAILS AND NOTES). PROVIDE STAINLESS STEEL BOLTS. |
| | CONTROL VALVE KEY |
| | CONTROLLER STATION ASSIGNMENT |
| | GPM SIZE |
| | ALL WIRING TO BE UL APPROVED #14 MIN. FOR DIRECT BURIAL, SOLID COPPER. INCREASE SIZE AS NECESSARY TO CONDUCT VOLTAGE, REQUIRED TO PROVIDE AUTOMATIC OPERATION OF ALL VALVES. |
| | WHERE PIPING AND WIRING INSTALLATIONS ARE TO BE SLEEVED, INSTALL IN SEPARATE SLEEVES. |
| | CONTRACTOR TO VERIFY A MINIMUM WATER PRESSURE OF 74 P.S.I. AT WATER SOURCE. |

UNLESS OTHERWISE NOTED ON IRRIGATION PLANS, ALL EXISTING AT OR ABOVE GRADE IRRIGATION COMPONENTS TO BE REMOVED. THIS INCLUDES, BUT IS NOT LIMITED TO, ELECTRIC VALVES, VALVE BOXES, SPRAY HEADS, BUBBLERS, EMITTER DISTRIBUTION LINES AND CONTROLLERS.
ALL EXISTING IRRIGATION BELOW GRADE (PVC PIPING) TO BE ABANDONED IN PLACE, UNLESS DISTURBED DURING NEW CONSTRUCTION. REMOVE AND DISPOSE AS NECESSARY.

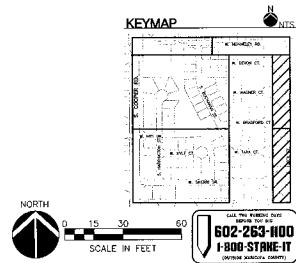

NO.	DATE	DESCRIPTION



McCloskey + Peltz, Inc.
LANDSCAPE ARCHITECTS
One West Elbow Road Suite 110
Tempe, Arizona 85284
Phone: (480) 838-0077
Fax: (480) 831-1774

Irrigation Plan
Parkway Improvement District 07-2
TEMPLETON PLACE
PREPARED FOR: Town of Gilbert

DESIGNED BY: MP1
DRAWN BY: BCD
CHECKED BY: DCM
PROJECT NO: 06422
DATE: 1/2008

DRAWING NO.
L-9
SHEET 9 OF 16

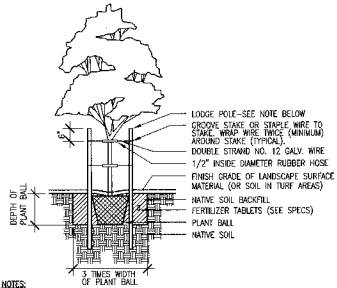

- NOTES:**
- HEIGHT OF STAKE VARIES. TOP BE PLACED FOR MAX. SUPPORT. BOTTOM BE PLACED MAINLY BETWEEN TOP 16 AND GRADE. SEE TREE STAKING DETAIL.
 - ONLY STAKE TREES THAT HAVE PREVIOUSLY BEEN STAKED IN THE NURSERY.
 - STAKES SHALL BE LOCATED AND INSTALLED SO AS TO NOT CONTACT THE ROOT BALL OR DAMAGE IRRIGATION SYSTEM WHEN DRIVEN INTO POSITION.

1 TREE PLANTING
N.T.S.

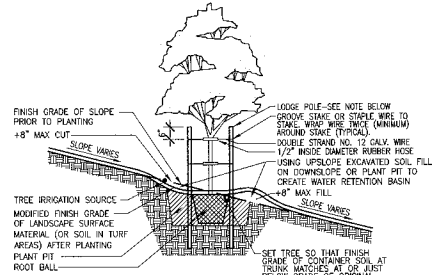

- NOTES:**
- PLANTING AND STAKING SHALL BE IN ACCORDANCE WITH DETAILS AND SPECIFICATIONS.
 - ALWAYS SET TREE TO MINIMIZE UPSLOPE CUT AND DOWNSLOPE FILL.
 - ROUND ALL CHANGES BETWEEN SURFACE SLOPE TRANSITIONS.
 - LOCATE IRRIGATION SOURCE ON UPSLOPE SIDE OF PLANT PIT.

2 TREE PLANTING ON SLOPE
N.T.S.

NOTE:
IT SHALL BE THE RESPONSIBILITY OF THE CONTRACTOR TO DETERMINE THE NEED TO INCREASE THE QUANTITY, HEIGHT AND DIAMETER OF TREE STAKES TO PROVIDE MAXIMUM SUPPORT AND INSURE STABILITY OF ALL TREES.

STAKES SHALL BE LOCATED AND INSTALLED SO AS TO NOT CONTACT THE ROOT BALL OR DAMAGE IRRIGATION SYSTEM WHEN DRIVEN INTO POSITION.

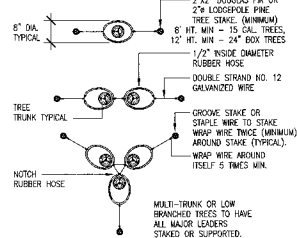

3 TREE STAKING DETAIL
N.T.S.

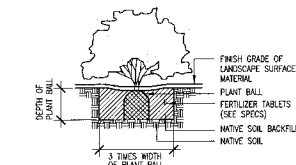

4 SHRUB PLANTING
N.T.S.

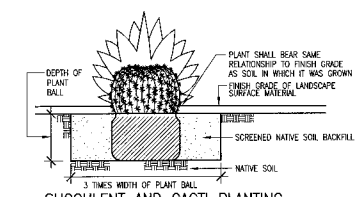

5 SUCCULENT AND CACTI PLANTING
N.T.S.

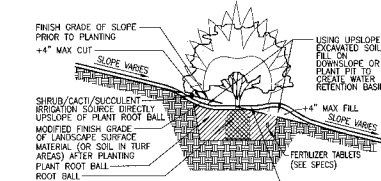

- NOTES:**
- PLANTING AND STAKING SHALL BE IN ACCORDANCE WITH DETAILS AND SPECIFICATIONS.
 - ALWAYS SET SHRUB/CACTI/SUCCULENT TO MINIMIZE UPSLOPE CUT AND DOWNSLOPE FILL.
 - ROUND ALL CHANGES BETWEEN SURFACE SLOPE TRANSITIONS.
 - LOCATE IRRIGATION SOURCE ON UPSLOPE SIDE OF PLANT ROOT BALL.

6 SHRUB/CACTI/SUCCULENT PLANTING ON SLOPE
N.T.S.

IF IMPERVIOUS SUBSURFACE CALICHE, ROCK OR HARDPAN EXISTS (BEHIND) EXCAVATED PLANT PIT, CONTRACTOR SHALL COMPLETE NECESSARY REMOVAL OR PENETRATION OF IMPERVIOUS MATERIAL TO PROVIDE NECESSARY PLANT PIT DRAINAGE AT A MINIMUM RATE OF 1 INCH PER HOUR. CONTRACTOR SHALL BE RESPONSIBLE FOR VERIFYING ADEQUATE PLANT PIT DRAINAGE PRIOR TO PLANT INSTALLATION.

ALL NATIVE SOIL BACKFILL WITHIN 18\"/>

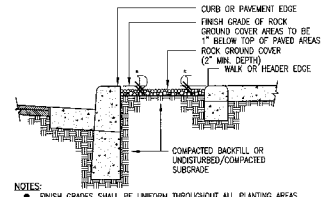

- NOTES:**
- FINISH GRADERS SHALL BE UNIFORM THROUGHOUT ALL PLANTING AREAS. ALL ROCK GROUND COVER DEPTH SHALL BE AFTER FINISH GRADING, WATER MOISTURE, AND SETTLEMENT.
 - CONTRACTOR SHALL BE RESPONSIBLE TO COORDINATE WITH OTHER PERFORMERS AS NECESSARY TO PROVIDE ALL FILL AND ROUGH GRADING REQUIRED TO ACHIEVE FINISH GRADE OF ROCK GROUND COVER AS INDICATED HEREIN.
 - WATER WASH ALL ROCK GROUND COVER SURFACES TO REMOVE FINES AND DUST.

7 FINISH GRADE ROCK GROUND COVER
N.T.S.

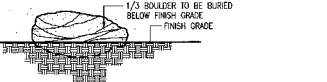

8 BOULDER INSTALLATION
N.T.S.

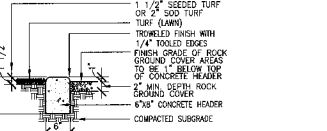

9 6\"/>

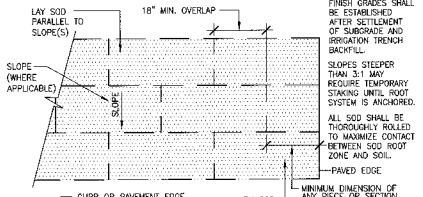

- SOODING NOTES:**
- FINISH GRADERS SHALL BE ESTABLISHED AFTER SETTLEMENT OF SUBGRADE AND IRRIGATION TRENCH BACKFILL.
 - SLOPES STEEPER THAN 3:1 MAY REQUIRE TEMPORARY STAKING UNTIL ROOT SYSTEM IS ANCHORED.
 - ALL SOD SHALL BE THOROUGHLY ROLLED TO MAXIMIZE CONTACT BETWEEN SOD, ROOT ZONE AND SOIL.
 - PAVED EDGE
 - MINIMUM DIMENSION OF ANY PIECE OR SECTION OF SOD SHALL BE 12\"/>

10 SOODING DETAIL
N.T.S.

8 BOULDER INSTALLATION
N.T.S.

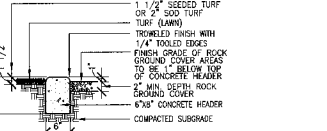

9 6\"/>

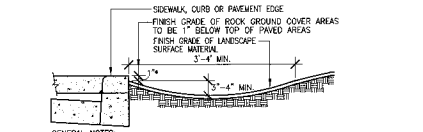

- GENERAL NOTES:**
- NUISANCE SWALES SHALL BE LOCATED BETWEEN ALL PAVEMENT EDGES AND ANY ADJACENT ELEVATED LANDSCAPE SURFACES.
 - FINISH GRADING (PRIOR TO PLACEMENT OF PLANTS AND ROCK GROUND COVER) SHALL INCLUDE GRADING / CONSTRUCTING NUISANCE SWALES.
 - 1/2\"/>

11 NUISANCE WATER SWALE
N.T.S.

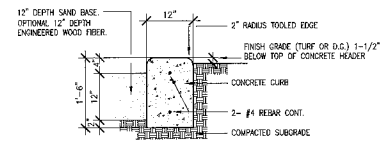

MAXIMUM SPACING OF CONTRACTION JOINTS IS 10' MAXIMUM SPACING OF EXPANSION JOINTS IS 30'

12 PLAY AREA CURB
N.T.S.

NO.	DATE	DESCRIPTION



McCloskey + Peltz, Inc.
LANDSCAPE ARCHITECTS
One West Elliot Road Suite 110
Tempe, Arizona 85283
Phone: (480) 831-9774
Fax: (480) 831-9777

Landscape Details
Parkway Improvement District 07-2
TEMPLETON PLACE
PREPARED FOR: **Town of Gilbert**

DESIGNED BY: **MPJ**
DRAWN BY: **BCD**
CHECKED BY: **DCM**
PROJECT NO: **08422**
DATE: **1/2008**

DRAWING NO.
L-10
SHEET **10** OF **16**

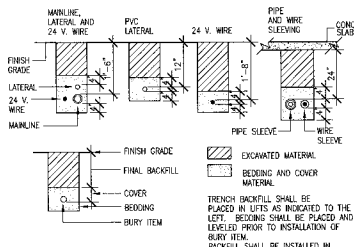

NOTE:

- SLEEVE ALL PIPE AND WIRE SEPARATELY
- ALL PIPE TO BE INSTALLED PER MANUFACTURER'S SPECIFICATIONS. PLASTIC PIPE TO BE "SAWED" IN TRENCHES. PROVIDE A MIN. OF 2" CLEARANCE TO SIDE OF TRENCH AND BETWEEN PIPES
- ALL 120 V. WIRING SHALL BE INSTALLED IN ACCORDANCE WITH LOCAL CODE REQUIREMENTS. TAPE AND BUNDLE WIRES EVERY 10', PROVIDE LOGS 20" LOOP AT ALL CHANGES OF DIRECTION OR 30'

1 IRRIGATION TRENCHING
N.T.S.

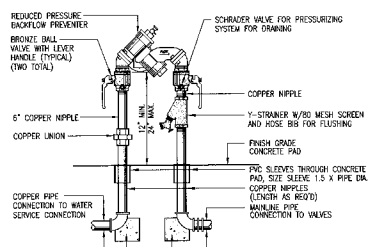

NOTE:

- LOCAL CODE SHALL GOVERN ALL INSTALLATION REQUIREMENTS
- ALL CONNECTIONS SHALL BE COPPER OR THREADED BRASS
- COORDINATE INSTALLATION OF CONCRETE SLAB AND BACKFLOW PREVENTER ENCLOSURE CASE IF INDICATED

2" OR SMALLER REDUCED PRESSURE BACKFLOW PREVENTER
N.T.S.

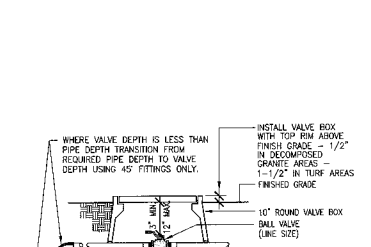

NOTE:

- INSTALL VALVE BOX WITH TOP FIN ABOVE FINISH GRADE - 1/2" IN DECOMPOSED GRANITE AREAS - 1-1/2" IN TURF AREAS

3 BALL VALVE/ISOLATION VALVE
N.T.S.

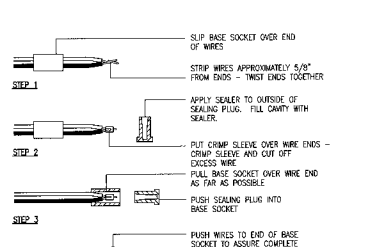

NOTE:

- FOR WIRE SIZES NO. 14, 12, AND 10 - ALL CONNECTIONS IN VALVE BOXES ONLY

4 TYPICAL WIRE CONNECTION
N.T.S.

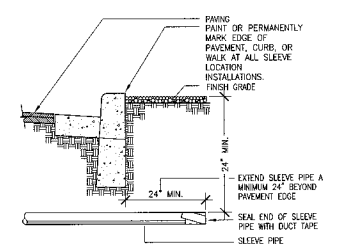

5 IRRIGATION SLEEVE
N.T.S.

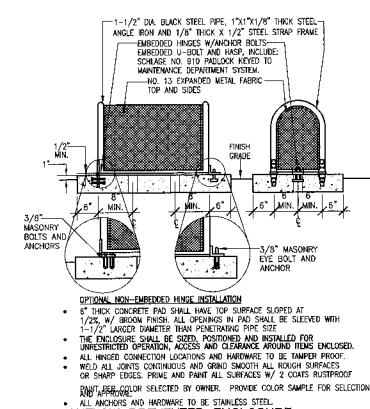

NOTE:

- 8" THICK CONCRETE PAD SHALL HAVE TOP SURFACE SLOPED AT 1/2% W/ BRONZ FINISH. ALL BIRMINGHAM IN PAD SHALL BE SLEEVED WITH 1-1/2" LARGER DIAMETER THAN PENETRATING PIPE SIZE
- THE ENCLOSURE SHALL BE SIZED, POSITIONED AND INSTALLED FOR UNRESTRICTED OPERATION, ACCESS AND CLEARANCE AROUND ITEMS ENCLOSED.
- ALL WELDED CONNECTION LOCATIONS AND HARDWARE TO BE TAMPER PROOF.
- WELD ALL JOINTS CONTINUOUS AND GRIND SMOOTH ALL ROUGH SURFACES OR SHARP EDGES. PRIME AND PAINT ALL SURFACES W/ 2 COATS RUSTPROOF.
- WELD COLOR SELECTED BY OWNER. PROVIDE COLOR SAMPLE FOR SELECTION
- ALL ANCHORS AND HARDWARE TO BE STAINLESS STEEL

6 BACKFLOW PREVENTER ENCLOSURE
N.T.S.

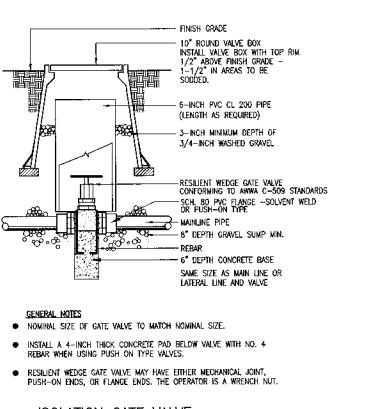

GENERAL NOTES:

- NOMINAL SIZE OF GATE VALVE TO MATCH NOMINAL SIZE.
- INSTALL 4-INCH THICK CONCRETE PAD BELOW VALVE WITH NO. 4 REBAR WHEN USING PUSH ON TYPE VALVES.
- RESILIENT WEDGE GATE VALVE MAY HAVE EITHER MECHANICAL JOINT, PUSH-ON ENDS, OR FLANGE ENDS. THE OPERATOR IS A WRENCH NOT.

7 ISOLATION GATE VALVE
N.T.S.

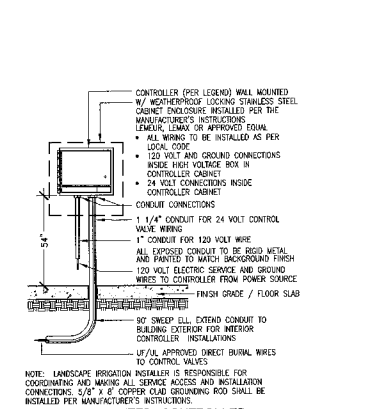

8 WALL MOUNTED CONTROLLER
N.T.S.

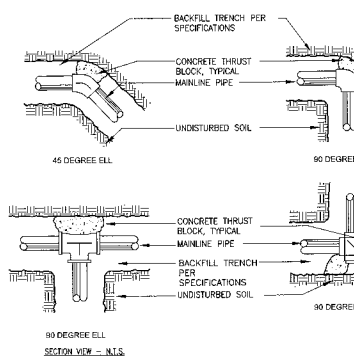

9 THRUST BLOCKS
N.T.S.

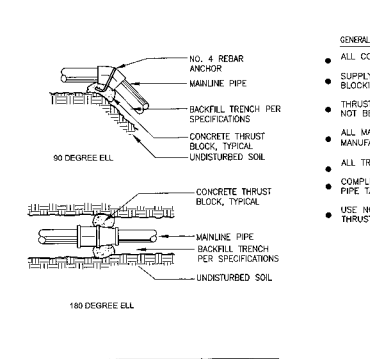

NOTE: PROVIDE SMOOTH EDGES FOR ALL CONCRETE AT THRUST BLOCKS TO AVOID DAMAGE TO PIPES

10 PEDESTAL MOUNTED CONTROLLER
N.T.S.

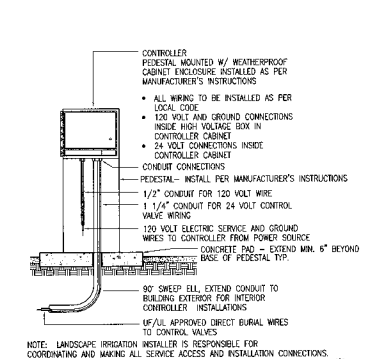

11 PEDESTAL MOUNTED CONTROLLER
N.T.S.

REVISION NO.	DATE	DESCRIPTION



McCloskey + Peltz, Inc.
LANDSCAPE ARCHITECTS
Tempe, Arizona No. 10774
One West Blvd. Suite 110
Scottsdale, AZ 85251

Irrigation Details
Parkway Improvement District 07-2
TEMPLETON PLACE
PREPARED FOR: Town of Gilbert

DESIGNED BY: MPI
DRAWN BY: BCD
CHECKED BY: DCM
PROJECT NO: 04-22
DATE: 12/08

DRAWING NO.
L-11
SHEET 11 OF 16

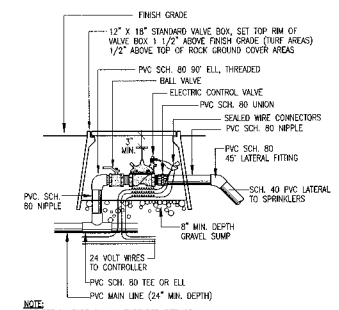

1 REMOTE CONTROL VALVE (TURF)
N.T.S.

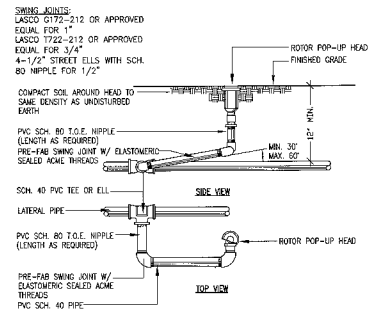

2 ROTOR HEAD W/ SWING JOINT
N.T.S.

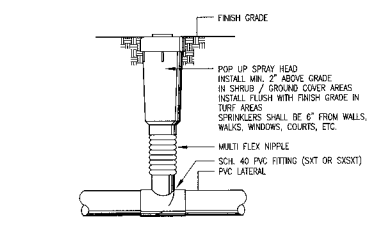

3 POP UP SPRAY HEAD
N.T.S.

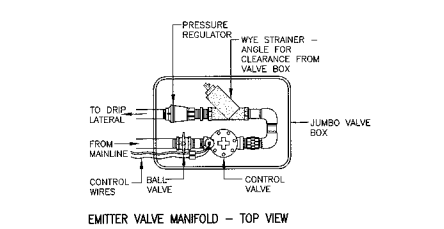

4 EMITTER VALVE MANIFOLD
N.T.S.

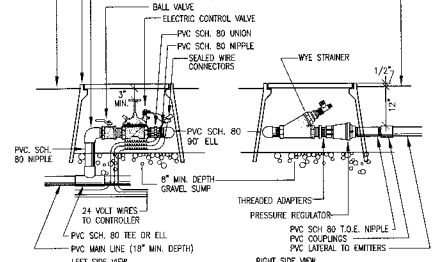

5 QUICK COUPLER VALVE
N.T.S.

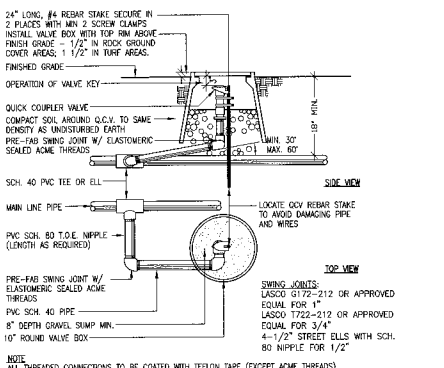

6 SINGLE OUTLET EMITTER
N.T.S.

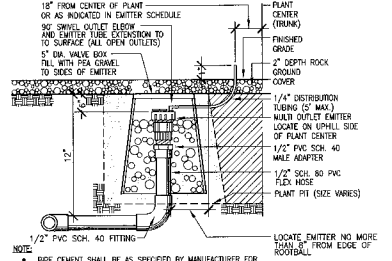

7 MULTI OUTLET EMITTER IN VALVE BOX
N.T.S.

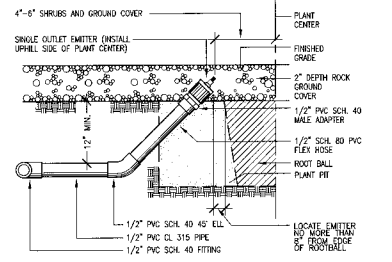

8 DRIP SYSTEM FLUSH PLUG
N.T.S.

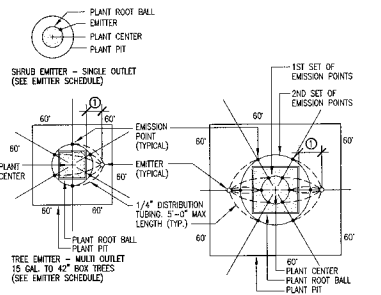

9 EMITTER LAYOUT
N.T.S.

TREES

TREE SIZE	NUMBER OF MULTI OUTLET EMITTERS = EMITTER QTY TOTAL	1ST SET OF EMISSON POINTS	2ND SET OF EMISSON POINTS
15 GAL.	1 - 1 GPH = 6 GPH	3 @ 12"	
24" BOX	1 - 1 GPH = 6 GPH	4 @ 18"	
30" BOX	1 - 1 GPH = 6 GPH	5 @ 21"	
36" BOX	1 - 2 GPH = 12 GPH	5 @ 24"	
42" BOX	1 - 2 GPH = 12 GPH	5 @ 24"	
48" BOX	2 - 2 GPH = 24 GPH	5 @ 12"	4 @ 42"
54" BOX	2 - 2 GPH = 24 GPH	5 @ 15"	5 @ 45"
EX. L.C. TREES	2 - 2 GPH = 24 GPH	5 @ 18"	5 @ 48"
EX. F. PALM	1 - 2 GPH = 12 GPH	6 @ 24"	
EX. F. PALM	1 - 2 GPH = 12 GPH	6 @ 24"	

SHRUBS

PLANT	SIZE	EMITTER TYPE (G.P.H.)
ANGELICA SHY, MARI'S BUELLA, RAIN LILY, AND PENTSTEMON	ALL	6 G.P.H. SINGLE OUTLET
ALL OTHER SHRUBS, GROUND COVER, AND ACCENTS	1 OR 5 GAL.	1 G.P.H. SINGLE OUTLET

10 EMITTER SCHEDULE
N.T.S.

PIPE SIZE	FLOW (GPM)	FLOW (GPM)
1/2"	6-4	0-5
3/4"	4-8	5-10
1"	8-13	10-15
1-1/4"	13-22	15-25
1-1/2"	22-30	25-35
2"	30-50	35-55
2-1/2"	50-70	55-80
3"	70-120	80-120
4"	120-200	120-200

11 PIPE SCHEDULE
N.T.S.

REVISIONS	NO.	DATE	DESCRIPTION



McCloskey + Peltz, Inc.
LANDSCAPE ARCHITECTS
One West Elliot Road Suite 110
Tempe, Arizona 85284
Phone: (480) 831-7774
Fax: (480) 831-0777

Irrigation Details
Parkway Improvement District 07-2
TEMPLETON PLACE
PREPARED FOR: Town of Gilbert

DESIGNED BY: MPI
DRAWN BY: BOD
CHECKED BY: DCM
PROJECT NO: 08422
DATE: 1/2008

DRAWING NO.
L-12
SHEET 12 OF 16

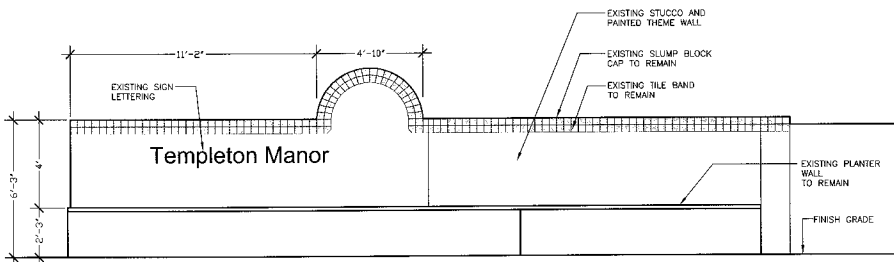

ENTRY MONUMENT EXISTING ELEVATION

3/8"=1'-0"

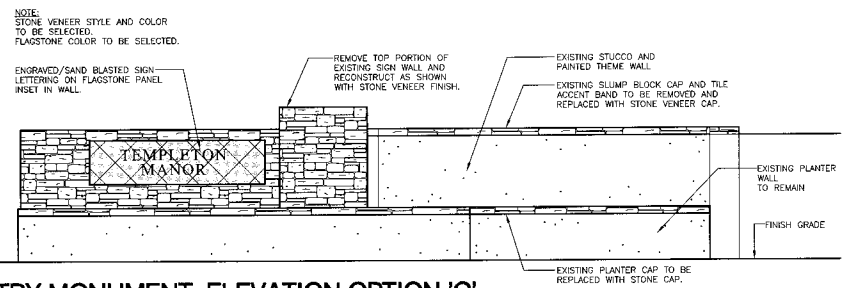

ENTRY MONUMENT ELEVATION OPTION 'C'

3/8"=1'-0"

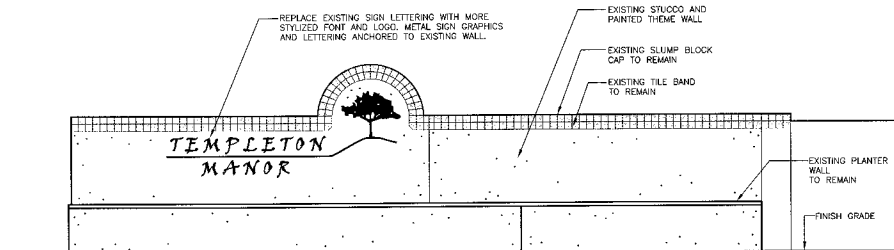

ENTRY MONUMENT ELEVATION OPTION 'A'

3/8"=1'-0"

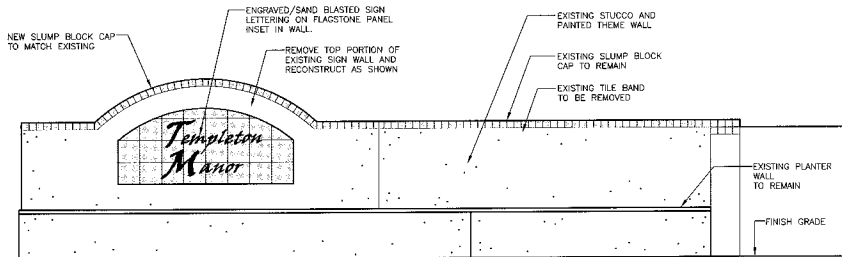

ENTRY MONUMENT ELEVATION OPTION 'D'

3/8"=1'-0"

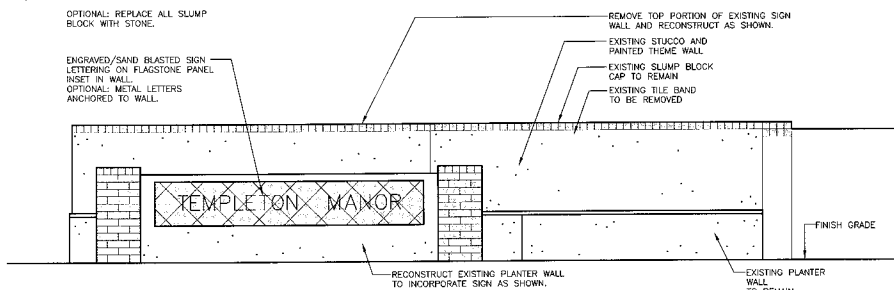

ENTRY MONUMENT ELEVATION OPTION 'B'

3/8"=1'-0"

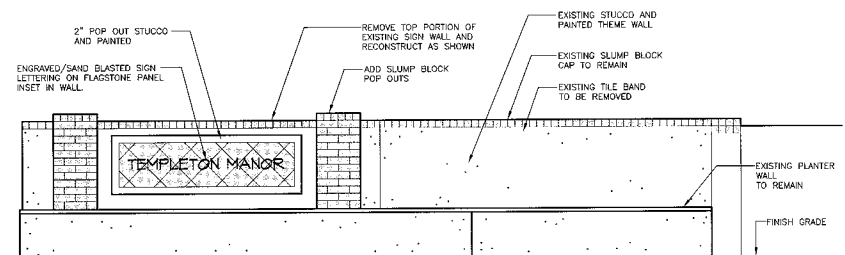

ENTRY MONUMENT ELEVATION OPTION 'E'

3/8"=1'-0"

NOTE: SELECTED ENTRY MONUMENT OPTION TO BE LIGHTED - LOW VOLTAGE FX LUMINAIRE SYSTEM INCLUDING GROUND MOUNTED LOW VOLTAGE LIGHT FIXTURES, WIRING, AND TRANSFORMER WITH ENCLOSURE DESIGNED AS REQUIRED AND APPROPRIATE FOR SELECTED SIGN DESIGN.

NOTE: STONE VENEER STYLE AND COLOR TO BE SELECTED. FLAGSTONE COLOR TO BE SELECTED.

NO.	DATE	DESCRIPTION



McCloskey + Peltz, Inc.
 LANDSCAPE ARCHITECTS
 1100 S. GARDNER AVE.
 TEMPLETON, CA 95275
 PHONE: (408) 267-9777 FAX: (408) 267-1774

Entry Monument Upgrade Options
 Parkway Improvement District 07-2
TEMPLETON PLACE
 PREPARED FOR: Town of Gilbert

DESIGNED BY: MPI
DRAWN BY: BCD
CHECKED BY: DCM
PROJECT NO: 06422
DATE: 1/2008

DRAWING NO.
L-13
 SHEET **13** OF **16**

