

MATCHLINE A SEE DRAWING L-3

MATCHLINE C SEE DRAWING L-4

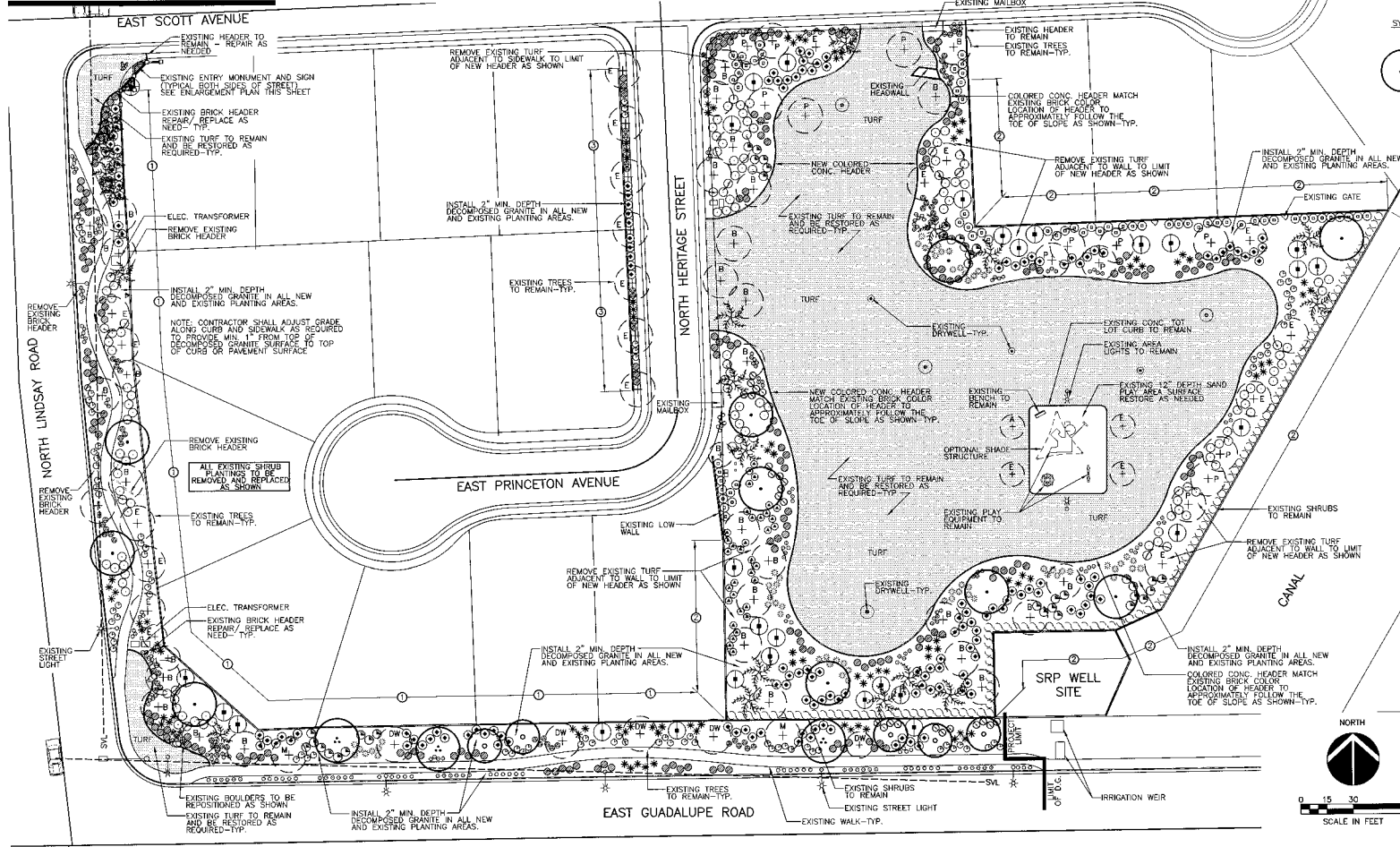

LANDSCAPE MATERIALS LIST

SYM.	BOTANICAL NAME COMMON NAME	SIZE
○	TREES	
○	PHILOSPIS LINEARIS	24" BOX
○	DESERT WILLOW	
○	PROSOPIS X 'PHOENIX'	24" BOX
○	THORNLESS MESQUITE HYBRID	
○	JULMUS PARVIFOLIA	24" BOX
○	EVERGREEN ELM	
SHRUBS, GROUND COVERS, AND ACCENTS		
*	AGAVE DESMETIANA	5 GAL.
▲	BOLSAVILLA 'LA JOLLA'	5 GAL.
▲	BOGANVILLEA	5 GAL.
①	CAESALPINA MEXICANA	5 GAL.
①	MEXICAN BIRD OF PARADISE	5 GAL.
①	CALLANDRA CALIFORNICA	5 GAL.
①	BALA FAIRY DUSTER	1 GAL.
①	CHALCIPICHA MEXICANA	5 GAL.
①	DAMIANITA	5 GAL.
①	EREMOPHILA MACULATA	5 GAL.
①	VALENTINE EMU BUSH	5 GAL.
①	HESPERALOE PARVIFLORA	5 GAL.
①	RED YUCCA	5 GAL.
①	LANTANA 'NEW GOLD'	1 GAL.
①	NEW GOLD LANTANA	5 GAL.
①	LEUCOPHYLLUM LANGMANIAE	1 GAL.
①	'TIO BRAVO' SAGE	5 GAL.
①	MULLENBERGIA CAPILLARIS	5 GAL.
①	PINK WUPLY 'REAL MIST'	5 GAL.
①	MULLENBERGIA RICENS	5 GAL.
①	DEER GRASS	5 GAL.
①	MEDIUM OLEANER	5 GAL.
①	'PETITE PINK' OLEANER	1 GAL.
①	ROSEMARYNS OFFICINALIS	5 GAL.
①	'HUNTINGTON CARPET'	1 GAL.
①	DWARF ROSEMARY	5 GAL.
①	RUELLIA BRITTONIANA	5 GAL.
①	RUELLIA	1 GAL.
①	RUELLIA BRITTONIANA 'KATIE'	5 GAL.
①	KATIE RUELLIA	5 GAL.
①	RUELLIA PENINSULARIS	5 GAL.
①	DESERT RUELLIA	15 GAL.
①	SOPHORA SECUNDFLORA	1 GAL.
①	TEXAS MOUNTAIN LAUREL	
①	TETRANERIS AQUIBUS	
①	ANGELITA DAISY	
○	TURF - SEED (NAME: SAHARA)	
○	OVERSIZED 'MADISON' SOO	
○	PLANTED OUT OF SEASON	
—	BRICK HEADER NEW/ RESTORE	
—	NEW CONCRETE HEADER	
ROCK GROUND COVER		
○	DECOMPOSED GRANITE, INSTALL 1/2" SCREENED 'MADISON GOLD'	
EXISTING TREE LEGEND		
○	EXISTING TREE TO REMAIN	
○	EXISTING TREE TO BE REMOVED	
○	EXISTING TREE TO BE REMOVED AND REPLACED WITH NEW TREE	
○	EXISTING TREE TO BE REMOVED AND REPLACED WITH NEW TREE	
○	EXISTING TREE TO BE REMOVED AND REPLACED WITH NEW TREE	
WALL LEGEND NOTES		
①	EXISTING STUCCO AND PAINTED THEM	
①	EXISTING STUCCO AND PAINTED THEM	
①	EXISTING STUCCO AND PAINTED THEM	
①	EXISTING STUCCO AND PAINTED THEM	

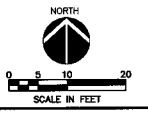
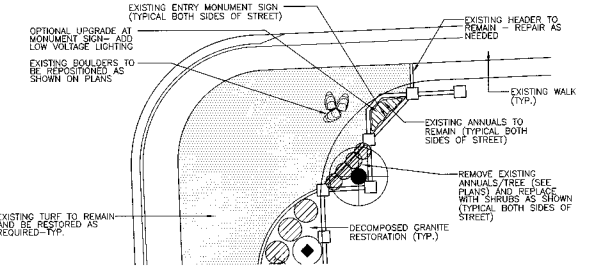
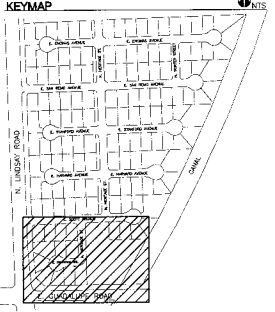
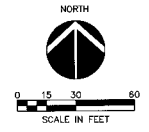

NO.	DATE	DESCRIPTION



McCloskey + Peltz, Inc.
LANDSCAPE ARCHITECTS
One West Elyot Road Suite 110
Tempe, Arizona 85284
Phone: (480) 834-8777

Planting Plan
Parkway Improvement District 07-6
CIRCLE G MEADOWS III
PREPARED FOR: Town of Gilbert

DESIGNED BY: MPI
DRAWN BY: MPI
CHECKED BY: DCM
PROJECT NO. 06422
DATE: 1/2008

DRAWING NO.
L-2
SHEET 2 OF 14

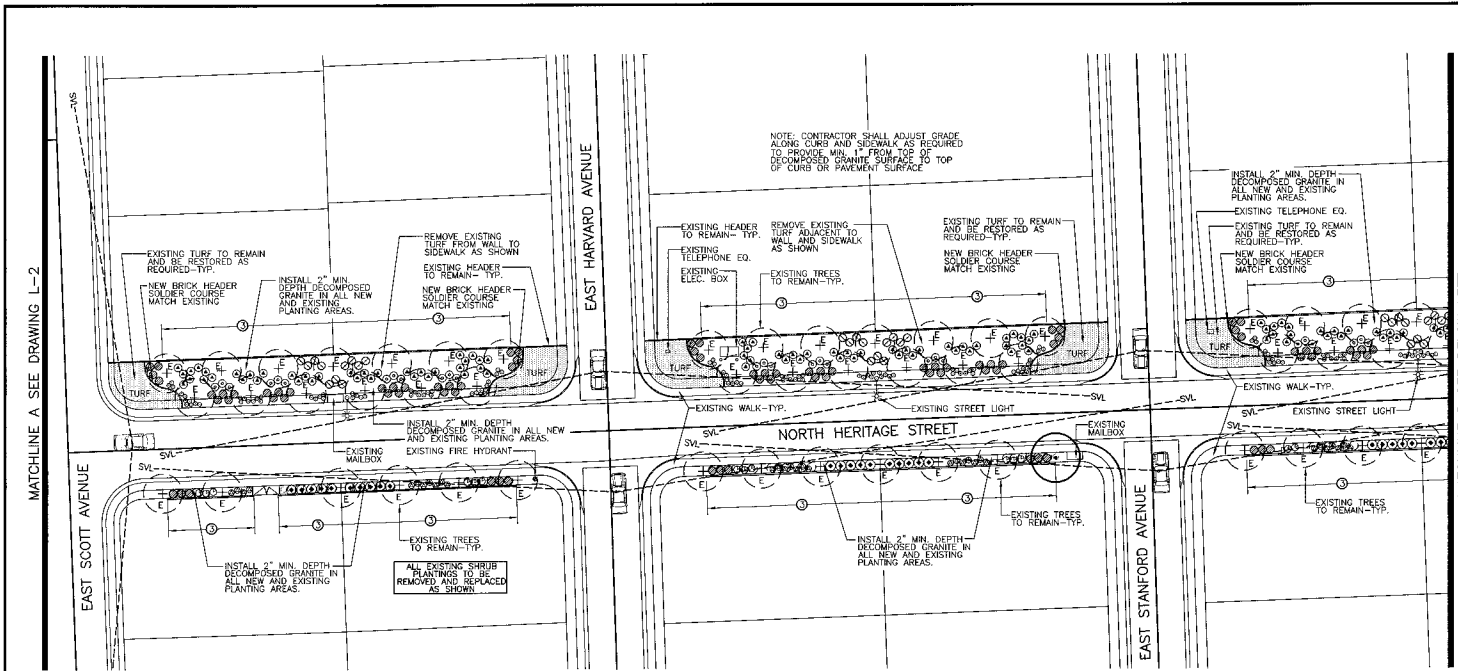

LANDSCAPE MATERIALS LIST

SYMBOL	BOTANICAL NAME	COMMON NAME	SIZE
○	CHLOPSIS LINEARIS	DESERT WILLOW	24" BOX
●	PROSOPIS X 'PHOENIX'	THORNLESS MESQUITE HYBRID	24" BOX
•	ULMUS PARVIFOLIA	EVERGREEN ELM	24" BOX
★	SHRUBS, GROUND COVERS, AND ACCENTS		
★	AGAVE DESMETTIANA	AGAVE	5 GAL.
▲	BOUCANVILLE 'LA JOLLA'	BOUCANVILLE	5 GAL.
①	CAESALPINIA MEXICANA	MEXICAN BIRD OF PARADISE	5 GAL.
②	CALLUNERA CALIFORNICA	BAJA FAIRY DUSTER	5 GAL.
③	CHRYSOCLADIA MEXICANA	DAMIANITA	1 GAL.
④	EREMOPHILA MACULATA	VALENTINE EMB. BUSH	5 GAL.
⑤	HESPERALOE PARVIFLORA	RED YUCCA	5 GAL.
⑥	LANTANA 'NEW GOLD'	NEW GOLD LANTANA	1 GAL.
⑦	LEUCOPHYLLUM LARGOMANIE	'RIO BRAVO' SAGE	5 GAL.
⑧	MULLENBERGIA CAPILLARIS	PINK MURLEY 'RECAL MIST'	5 GAL.
⑨	MULLENBERGIA RIGENS	DEER GRASS	5 GAL.
⑩	NERIUM OLEANDER	'PETITE PINK' OLEANDER	5 GAL.
⑪	ROMARINUS OFFICINALIS	'HUNTINGTON CARPET'	1 GAL.
⑫	DIWANE ROSEMARY	DIWANE ROSEMARY	5 GAL.
⑬	RUELLIA BRITTONIANA	'KATIE' RUELLIA	1 GAL.
⑭	RUELLIA PENINSULARIS	DESERT RUELLIA	5 GAL.
⑮	SOPHORA SECUNDIFLORA	TEXAS MOUNTAIN LAUREL	15 GAL.
⑯	TETRANEURUS ACALULIS	'ANGELITA DAISY'	1 GAL.
○	TURF-SEED (NUMEX SAMBARA)	OVERSEEDED 'MIRKENT' SOG IF PLANTED OUT OF SEASON	
—	BRICK HEADER NEW / RESTORE		
—	NEW CONCRETE HEADER		
—	ROCK GROUND COVER		
—	DECOMPOSED GRANITE, INSTALL 1/2" SCREENED MADISON BLDG. 2" MIN. DEPTH IN ALL LANDSCAPE PLANTING AREAS.		

- #### EXISTING TREE LEGEND
- EXISTING TREE TO REMAIN
 - EXISTING TREE TO REMAIN
 - EXISTING TREE TO REMAIN
 - EXISTING PALM TREE TO REMAIN
- #### WALL LEGEND NOTES
- ① EXISTING STUCCO AND PAINTED THEME WALL WITH BRICK COLUMNS MAINTAINED BY THE TOWN OF GILBERT
 - ② EXISTING INTEGRAL COLOR BLOCK WALL MAINTAINED BY THE TOWN OF GILBERT
 - ③ EXISTING STUCCO AND PAINTED WALL MAINTAINED BY THE TOWN OF GILBERT

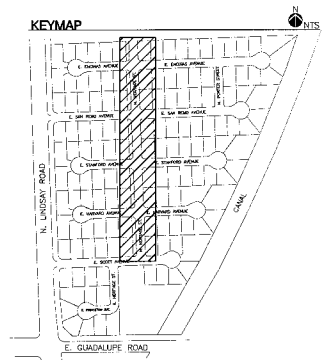
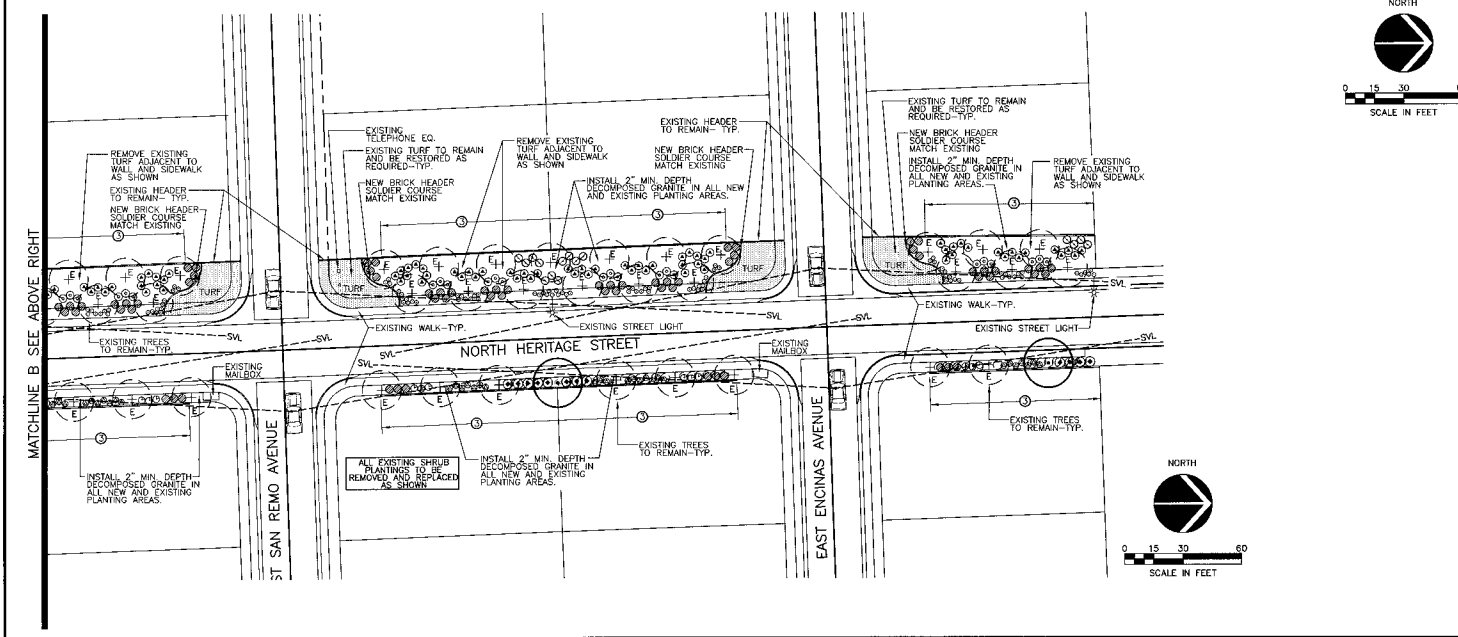

REVISIONS	NO.	DATE	DESCRIPTION



McCloskey • Peltz, Inc.
 LANDSCAPE ARCHITECTS
 Tempe, Arizona 85283
 One West Bldg. 10022 State 110
 Phone: (480) 831-7171

Planting Plan
 Parkway Improvement District 07-6
CIRCLE G MEADOWS III
 PREPARED FOR: Town of Gilbert

DESIGNED BY: MPI
 DRAWN BY: MPI
 CHECKED BY: DCM
 PROJECT NO: 06422
 DATE: 1/2008

DRAWING NO.
L-3
 SHEET 3 OF 14

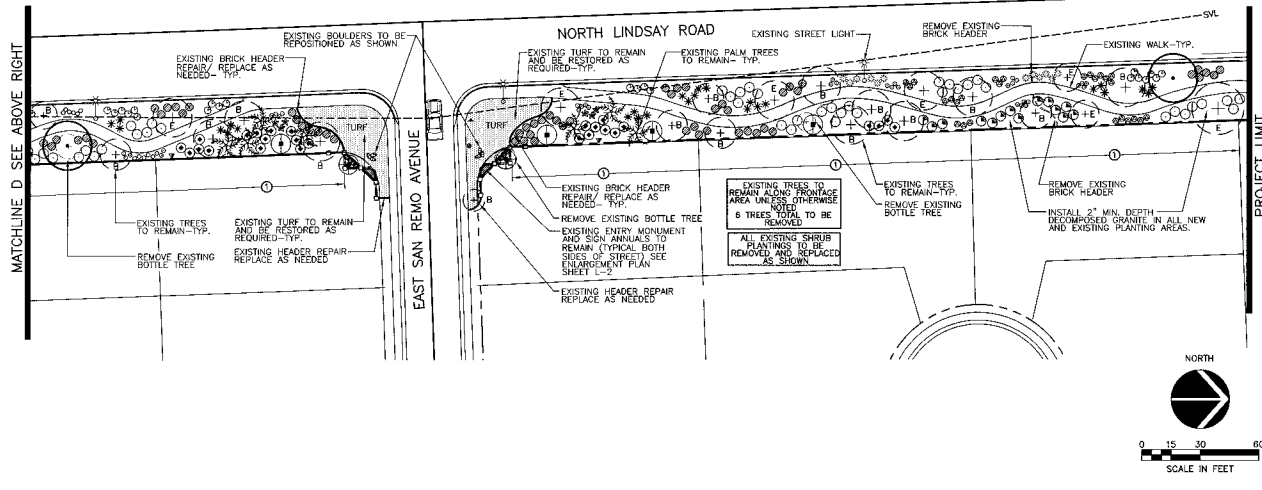
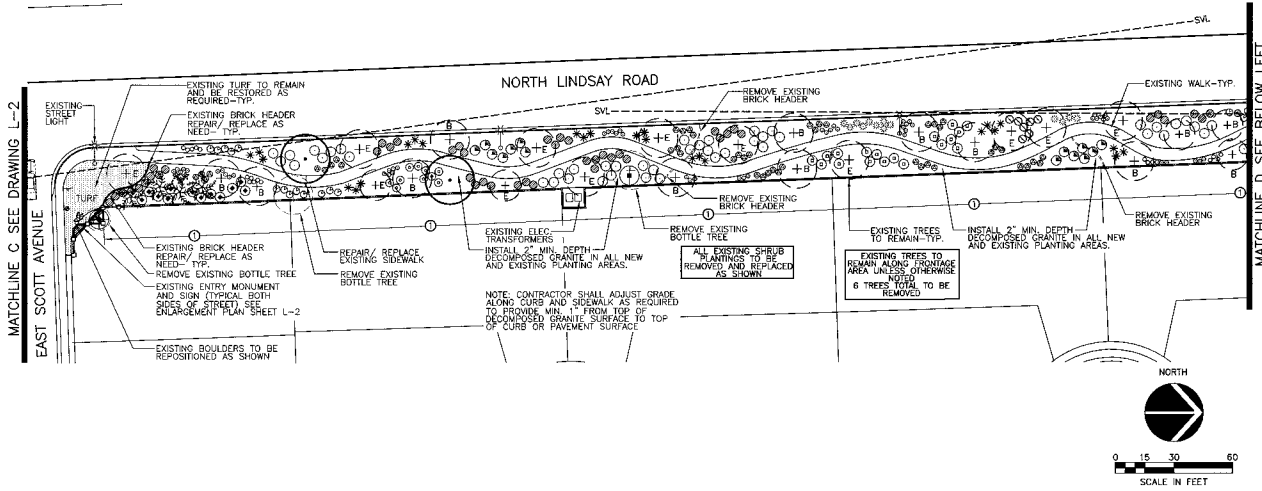

LANDSCAPE MATERIALS LIST

SYM.	BOTANICAL NAME COMMON NAME	SIZE
TREES		
○	CHILOPSIS LINEARIS DESERT WILLOW	24" BOX
○	PROSOPIS X 'PHOENIX' 'THORNLESS MESQUITE' HYBRID	24" BOX
○	ULMUS PARVIFOLIA EVERGREEN ELM	24" BOX
SHRUBS, GROUND COVERS, AND ACCENTS		
★	AGAVE DESMETRIANA AGAVE	5 GAL.
▲	BOUGAINVILLEA 'LA JOLLA' BOUGAINVILLEA	5 GAL.
①	CAESALPINIA MEXICANA MEXICAN BIRD OF PARADISE	5 GAL.
②	CALLIPHYLLIS CALIFORNICA BAJA FAIRY DUSTER	5 GAL.
③	CHRYSOACTINIA MEXICANA DAMIANITA	1 GAL.
④	EREMOPHILA MACULATA VALENTINE EMBLUSH	5 GAL.
✱	HESPERALOE PARVIFLORA RED TUCCA	5 GAL.
○	LANTANA 'NEW GOLD' NEW GOLD LANTANA	1 GAL.
○	LEUCOPHYLLUM LANGHAMIAE RIO BRAVO SAGE	5 GAL.
⑤	MUHLENBERGIA CAPILLARIS PINK MUHLY 'REGAL MIST'	5 GAL.
⑥	MUHLENBERGIA RICENS DEER GRASS	5 GAL.
⑦	NEURUM OLEANDER 'PETITE PINK' OLEANDER	5 GAL.
⑧	ROSMARINUS OFFICINALIS 'HUNTINGTON CARPET' DWARF ROSEMARY	1 GAL.
⑨	RUELLIA BRITTONIANA RUELLIA	5 GAL.
○	RUELLIA BRITTONIANA 'KATIE' KATIE RUELLIA	1 GAL.
○	RUELLIA PENNSULARIS DESERT RUELLIA	5 GAL.
⊕	SOPHORA SECUNDFLORA TEXAS MOUNTAIN LAUREL	15 GAL.
○	TETRAHEIS ACULIS ANGELITA DAISY	1 GAL.
TURF-SEED (NUMEX SAHARA) OVERSEEDED MEDIUM SOD IF PLANTED OUT OF SEASON		
BRICK HEADER NEW/ RESTORE		
NEW CONCRETE HEADER		
BACK GROUND COVER DECOMPOSED GRANITE. INSTALL 1/2" SCREENED MASON GOLD. 2" MIN. DEPTH IN ALL LANDSCAPE PLANTING AREAS.		
EXISTING TREE LEGEND		
○	EXISTING TREE TO REMAIN	TREE
○	BOTTLE TREE TO REMAIN	BOTTLE TREE
○	THORNLESS MESQUITE TO REMAIN	THORNLESS MESQUITE
○	EXISTING PALM TREE TO REMAIN	PALM TREE
WALL LEGEND NOTES		
①	EXISTING STUCCO AND PAINTED THEME WALL WITH BRICK COLUMNS MAINTAINED BY THE TOWN OF GILBERT	
②	EXISTING INTEGRAL COLOR BLOCK WALL MAINTAINED BY THE TOWN OF GILBERT	
③	EXISTING STUCCO AND PAINTED WALL MAINTAINED BY THE TOWN OF GILBERT	

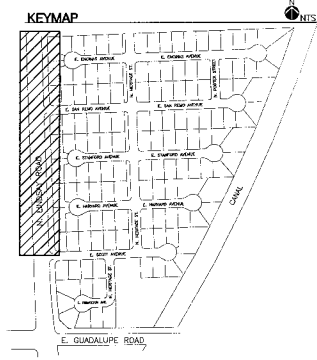
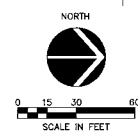
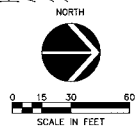

NO.	DATE	DESCRIPTION



McCloskey + Peltz, Inc.
LANDSCAPE ARCHITECTS
Tempe, Arizona 85284
One West Elyot Road Suite 110
Phone: (480) 968-0777
Fax: (480) 968-1774

Planting Plan
Parkway Improvement District 07-6
CIRCLE G MEADOWS III
PREPARED FOR: Town of Gilbert

DESIGNED BY: MP1
DRAWN BY: MP1
CHECKED BY: DCM
PROJECT NO: 08422
DATE: 1/2008

DRAWING NO.
L-4
SHEET 4 OF 14

MATCHLINE C SEE DRAWING L-7

MATCHLINE A SEE DRAWING L-6

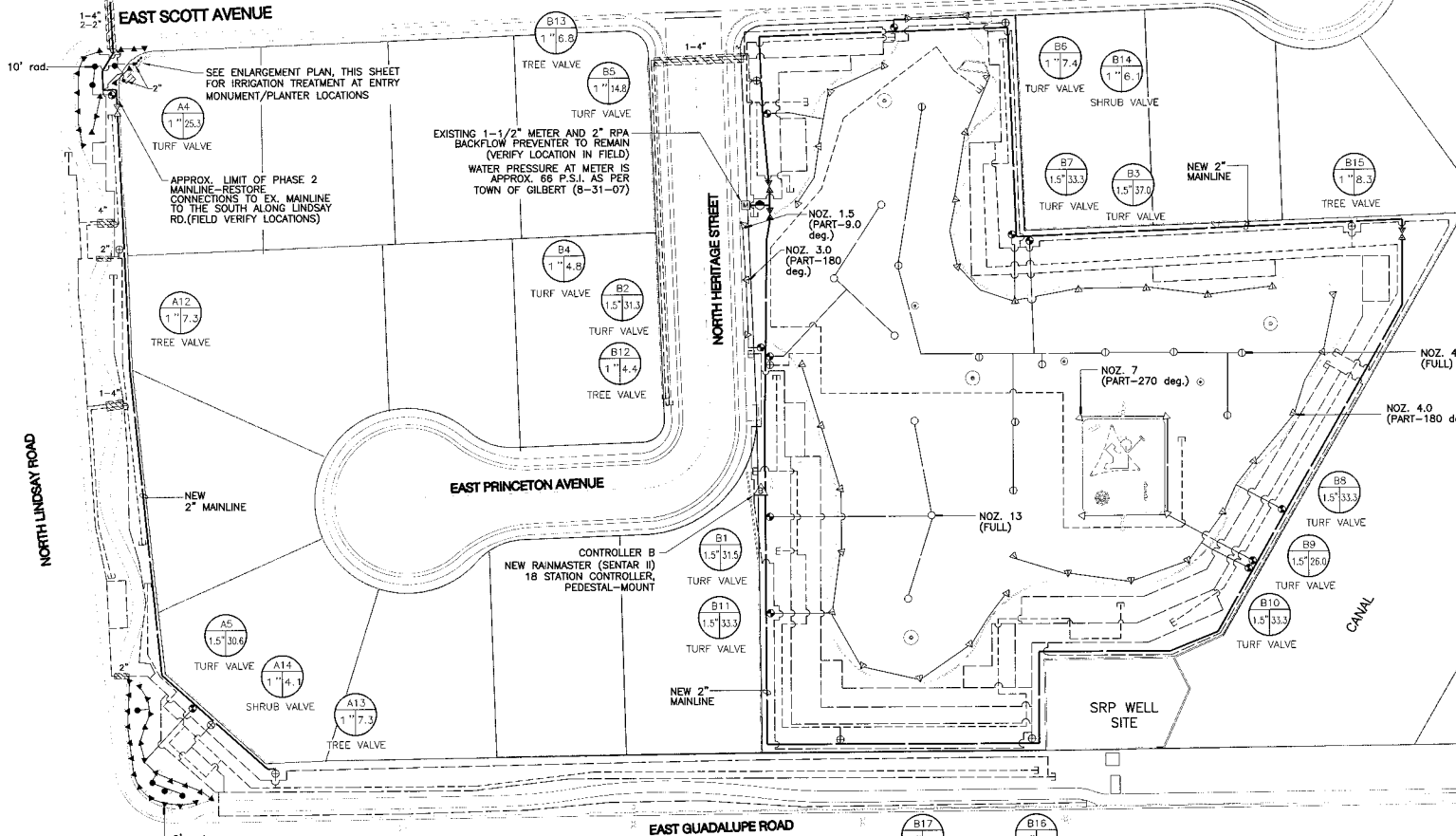

IRRIGATION MATERIALS LEGEND

- SYMBOL**
- EXISTING WATER METER (SIZE AND LOCATION AS SHOWN ON PLANS)
 - EXISTING BACKFLOW PREVENTER (SEE PLANS FOR LOCATION)
 - NEW SCHEDULE 40 PVC SLEEVE (ALL PIPING AND WIRING UNDER PAVEMENT TO BE SCHEDULED (SIZE AS NOTED))
 - NEW MAINLINE SCHEDULE 40 PVC - 2-1/2" AND SMALLER (SIZE AS NOTED)
 - NEW ISOLATION BALL VALVE-2" AND SMALLER-NIBCO MODEL 1-900 (LINE SIZE) (SEE DETAIL)
 - NEW ENTRY VALVE MANIFOLD ASSEMBLY INCLUDES: RAINBIRD PEI ELECTRIC REMOTE CONTROL VALVE, LINE SIZE BRASS RESILIENT SEATED BALL VALVE WITH FULL PORT OPENINGS; AG PRODUCTS 4C ELASTIC BRN CLEAN FILTER WITH 100 MESH SCREEN; AND SENNINGER LOW FLOW PRESSURE REDUCING VALVE (FOR FLOWS 2-20 GPM) (PNW-30MFT) - 3/4" PRESET AT 30 PSI (SEE DETAIL)
 - NEW REMOTE CONTROL VALVE - (SIZE PER PLAN) RAINBIRD PEI SERIES ELECTRIC REMOTE CONTROL VALVE, LINE SIZE BRASS RESILIENT SEATED BALL VALVE WITH FULL PORT OPENINGS ON INLET.
 - NEW LATERAL (SIZE PER SCHEDULE), CLASS 200 PVC PIPE
 - NEW 3/4" DRIP LATERAL, CLASS 200 PVC PIPE (UNLESS OTHERWISE NOTED ON PLANS)
 - NEW 3/4" DRIP LATERAL, CLASS 200 PVC PIPE (UNLESS OTHERWISE NOTED ON PLANS)
 - 1/2" DRIP SUBLATERAL (NOT SHOWN), CLASS 100 PVC PIPE - ALL SUBLATERAL PIPES SHALL BE PVC CLASS 315 - PROVIDE AND INSTALL FULL SUBLATERAL PIPE LENGTHS AND FITTINGS AS NECESSARY FROM LATERAL PIPE TO EMITTER INSTALLATION AT EACH PLANT (SEE DETAILS)
 - HUNTER I-20-ADS, I-20-365 4" POP-UP ROTOR TURF SPRAY
 - HUNTER I-60-365 4" POP-UP ROTOR TURF SPRAY
 - HUNTER INSTITUTIONAL SERIES - 4" POP UP TURF SPRAY HEADS
8 SERIES - 7'-10" RADIUS
10 SERIES - 10" RADIUS
 - NEW MULTI OUTLET EMITTER - BONSMAITH M200 SERIES - (1.0 AND 2.0 GPH OUTLETS @ 20 PSI) (TREES) WITH SWIVEL OUTLET 90° ELBOWS FOR EACH DISTRIBUTION TUBE (SEE DETAILS AND SCHEDULE)
 - NEW SINGLE OUTLET EMITTER - BONSMAITH S200 SERIES - (0.8 AND 1.0 GPH OUTLETS @ 20 PSI) (SHRUBS) (SEE DETAIL AND SCHEDULE)
 - RAINBIRD 1401 (25 gph) PRESSURE COMPENSATING FULL-CIRCLE BUBBLER
 - DRIP SYSTEM FLUSH PLUG OUTLET (SEE DETAIL)
 - ELECTRIC SOLID STATE CONTROLLER, RAINMASTER ONE SERIAL, I-SIZE AS NOTES ON PLANS. PROVIDE WITH HEAVY DUTY LIGHTNING/SURGE PROTECTION. WIRING AND ELECTRICAL CONDUIT (SCHEDULE 80, CSM) FOR CONTROLLER POWER SERVICE CONNECTION.
 - ALL IRRIGATION VALVE BOXES TO BE CARSON/BROOKS AMETEK OR EQUAL BOLT DOWN LID WORKS (PINK COLOR IN GRANITE AREAS, GREEN IN TURF AREAS) (SEE DETAILS AND NOTES). PROVIDE STAINLESS STEEL BOLTS.
 - CONTROL VALVE KEY
CONTROLLER STATION ASSIGNMENT
SIZE
 - ALL WIRING TO BE UL APPROVED #14 MIN FOR DIRECT BURIAL. SOLID COPPER - REDUCE SIZE AS NECESSARY TO CONDUCT VOLTAGE REQUIRED TO PROVIDE AUTOMATIC OPERATION OF ALL VALVES.
 - WHERE PIPING AND WIRING INSTALLATIONS ARE TO BE SEPARATE, INSTALL IN SEPARATE SLEEVES.
 - CONTRACTOR TO VERIFY A MINIMUM WATER PRESSURE OF 60 P.S.I. AT WATER SOURCE.

REVISION NO.	DATE	DESCRIPTION



McCloskey • Peltz, Inc.
LANDSCAPE ARCHITECTS
One West Broadway Suite 110
Tempe, Arizona 85282
Phone: (480) 967-9777

Irrigation Plan
Parkway Improvement District 07-6
CIRCLE G MEADOWS III
PREPARED FOR: Town of Gilbert

DESIGNED BY: MPI
DRAWN BY: MPI
CHECKED BY: DCM
PROJECT NO: 06422
DATE: 1/2008

DRAWING NO:
L-5
SHEET 5 OF 14

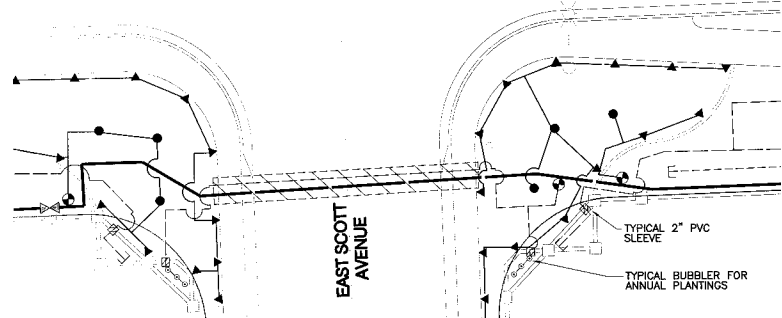

TYPICAL ENTRY MONUMENT/IRRIGATION ENLARGEMENT PLAN
LOCATED AT LINDSAY ROAD AND SCOTT AVENUE SCALE: 1"=10'-0"

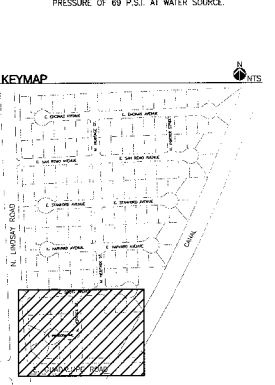
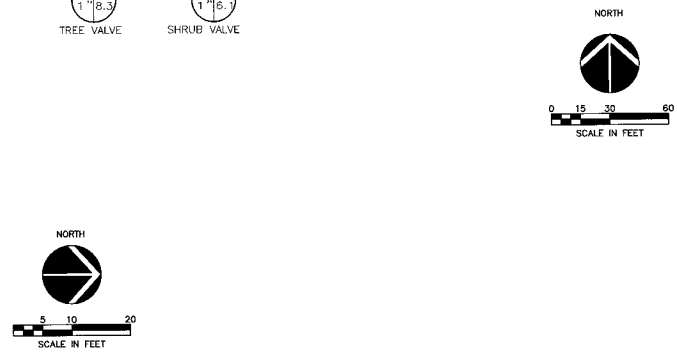

MATCHLINE A SEE DRAWING L-5

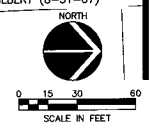
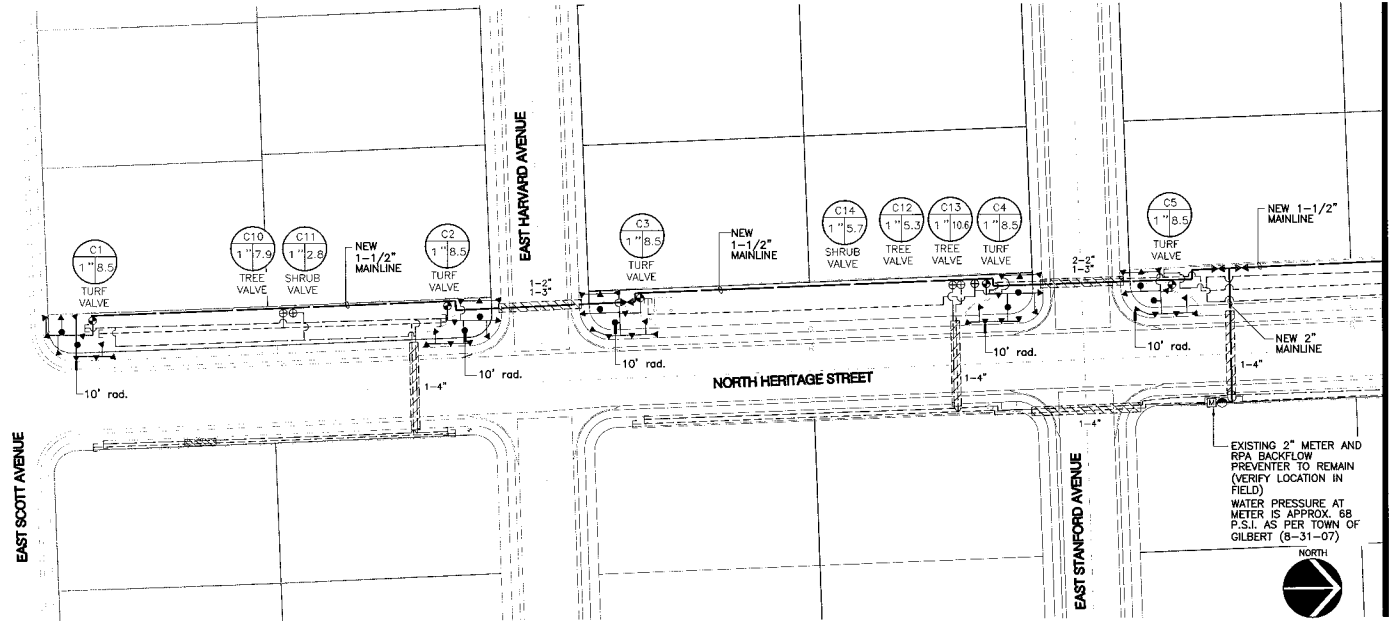

MATCHLINE B SEE ABOVE RIGHT

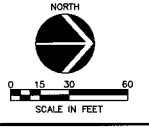
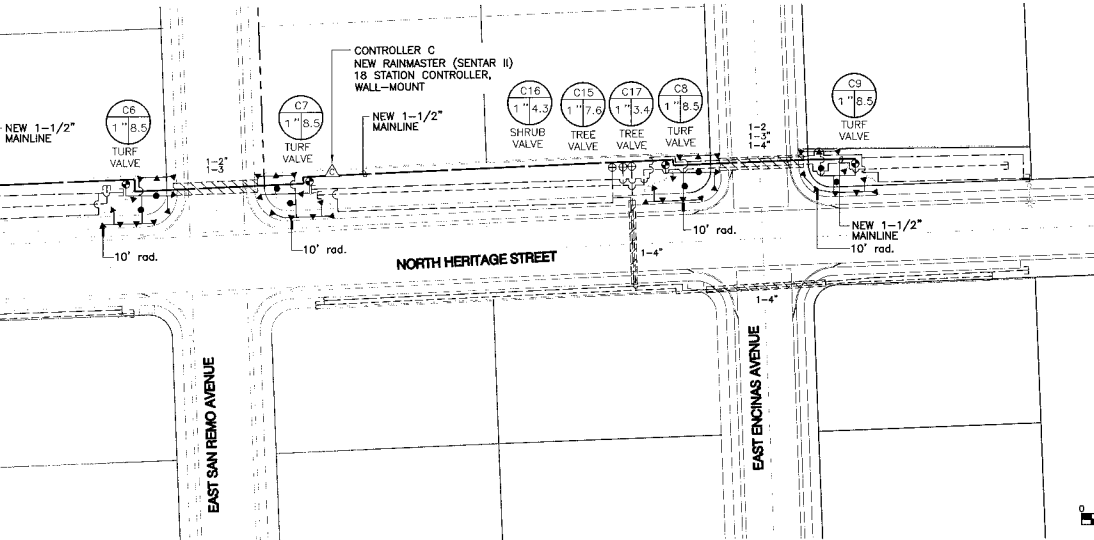

IRRIGATION MATERIALS LEGEND

- | SYMBOL | DESCRIPTION |
|--------|---|
| ⊕ | EXISTING WATER METER (SIZE AND LOCATION AS SHOWN ON PLANS) |
| ⊖ | EXISTING BACKFLOW PREVENTER (SEE PLANS FOR LOCATION) |
| --- | NEW SCHEDULE 40 PVC SLEEVE (ALL PIPING AND WIRING UNDER PAVEMENT TO BE SLEEVED) (SIZE AS NOTED) |
| --- | NEW MAINLINE SCHEDULE 40 PVC - 2-1/2" AND SMALLER (SIZE AS NOTED) |
| --- | NEW ISOLATION BALL VALVE-2" AND SMALLER-NIBCO MODEL 1-585 (LINE SIZE) (SEE DETAIL) |
| ⊕ | NEW EMITTER VALVE MANIFOLD ASSEMBLY INCLUDES: RAINBOW PER SERIES ELECTRIC REMOTE CONTROL VALVE, LINE SIZE BRASS RESILIENT SEATED BALL VALVE WITH FULL PORT OPENINGS AS PRODUCTS 4" PLASTIC SPIN CLEAN FILTER WITH 150 MESH SCREEN, AND SENSINGER LOW FLOW PRESSURE REDUCING VALVE (FOR FLOWS 1-8 GPM) (PAIR-50L) OR MEDIUM FLOW PRESSURE REDUCING VALVE (FOR FLOWS 2-20 GPM) (PAIR-30MF) - 3/4" PRESET AT 30 PSI (SEE DETAIL) |
| ⊕ | NEW REMOTE CONTROL VALVE - (SEE PER PLAN) RAINBOW PER SERIES ELECTRIC REMOTE CONTROL VALVE WITH LINE SIZE BRASS RESILIENT SEATED BALL VALVE WITH FULL PORT OPENINGS ON INLET. |
| --- | NEW LATERAL (SIZE PER SCHEDULE), CLASS 200 PVC PIPE |
| --- | NEW 1/4" DRIP LATERAL, CLASS 200 PVC PIPE (UNLESS OTHERWISE NOTED ON PLANS) |
| --- | NEW 3/4" DRIP LATERAL, CLASS 200 PVC PIPE (UNLESS OTHERWISE NOTED ON PLANS) |
| --- | 1/2" DRIP SUBLATERAL (NOT SHOWN), CLASS 316 PVC PIPE, ALL SUBLATERAL PIPE SHALL BE PVC CLASS 316, PROVIDE AND INSTALL ALL SUBLATERAL PIPE LENGTHS AND FITTINGS AS NECESSARY FROM LATERAL TO EMITTER INSTALLATION AT EACH PLANT (SEE DETAILS) |
| --- | HUNTER I-20-ADS, I-20-365 4" POP-UP ROTOR TURF SPRAY |
| --- | STANDARD NOZZLES AS LABELED ON PLANS |
| --- | HUNTER I-60-365 4" POP-UP ROTOR TURF SPRAY |
| --- | HUNTER INSTITUTIONAL SERIES - 4" POP UP TURF SPRAY HEADS
8 SERIES - 7'-10" RADIUS
10 SERIES - 10' RADIUS |
| --- | NEW MULTI OUTLET EMITTER - BOWSMITH M200 SERIES - 1.0 AND 2.0 GPM OUTLETS @ 20 PSI (CHECKS) WITH SWIVEL OUTLET 90° ELBOWS FOR EACH DISTRIBUTION TUBE (SEE DETAILS AND SCHEDULE) |
| --- | NEW SINGLE OUTLET EMITTER - BOWSMITH S200 SERIES - 0.6 AND 1.0 GPM OUTLETS @ 20 PSI (SHRUBS) (SEE DETAIL AND SCHEDULE) |
| --- | RAINBOW 1401 (2.0 gpm) PRESSURE COMPENSATING FLUIDIBLE BUBBLER |
| --- | DRIP SYSTEM FLUSH PLUG OUTLET (SEE DETAIL) |
| --- | ELECTRIC SOLID STATE CONTROLLER, RAINMASTER PER SENTAR II-SIZE AS NOTED ON PLANS, PROVIDE WITH HEAVY DUTY LIGHTNING/SURGE PROTECTION |
| --- | WIRING AND ELECTRICAL CONDUIT (SCHEDULE 80, GRAY) FOR CONTROLLER POWER SERVICE CONNECTION. |
| --- | ALL IRRIGATION VALVE BOXES TO BE CARSON/BROOKS AMETEK OR EQUAL BOLT DOWN UID MODELS (TAN COLOR IN GRANITE AREAS, GREEN IN TURF AREAS) (SEE DETAILS AND NOTES), PROVIDE STAINLESS STEEL BOLTS. |
| --- | CONTROL VALVE KEY CONTROLLER STATION ASSIGNMENT |
| --- | SIZE |
| --- | ALL WIRING TO BE UL APPROVED #14 MIN FOR DIRECT BURIAL, SOLID COPPER, WIRELESS SIZE AS NECESSARY TO CARRY VOLTAGE REQUIRED TO PROVIDE AUTOMATIC OPERATION OF ALL VALVES. |
| --- | WHERE PIPING AND WIRING INSTALLATIONS ARE TO BE SLEEVED, INSTALL IN SEPARATE SLEEVES. |
| --- | CONTRACTOR TO VERIFY A MINIMUM WATER PRESSURE OF 60 P.S.I. AT WATER SOURCE. |

KEYMAP

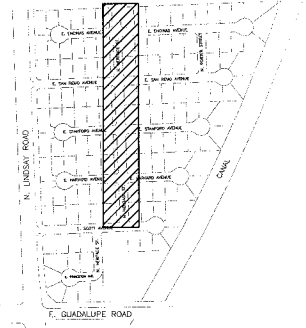

NO.	DATE	DESCRIPTION



McCloskey • Peitz, Inc.
 LANDSCAPE ARCHITECTS
 One West Elster Road Suite 110
 Tempe, Arizona 85284
 Phone: (602) 834-0777
 Fax: (602) 834-0777

Irrigation Plan
 Parkway Improvement District 07-6
CIRCLE G MEADOWS III
 PREPARED FOR: Town of Gilbert

DESIGNED BY: MPI
 DRAWN BY: MPI
 CHECKED BY: DCM
 PROJECT NO: 06422
 DATE: 1/2008

DRAWING NO:
L-6
 SHEET 6 OF 14

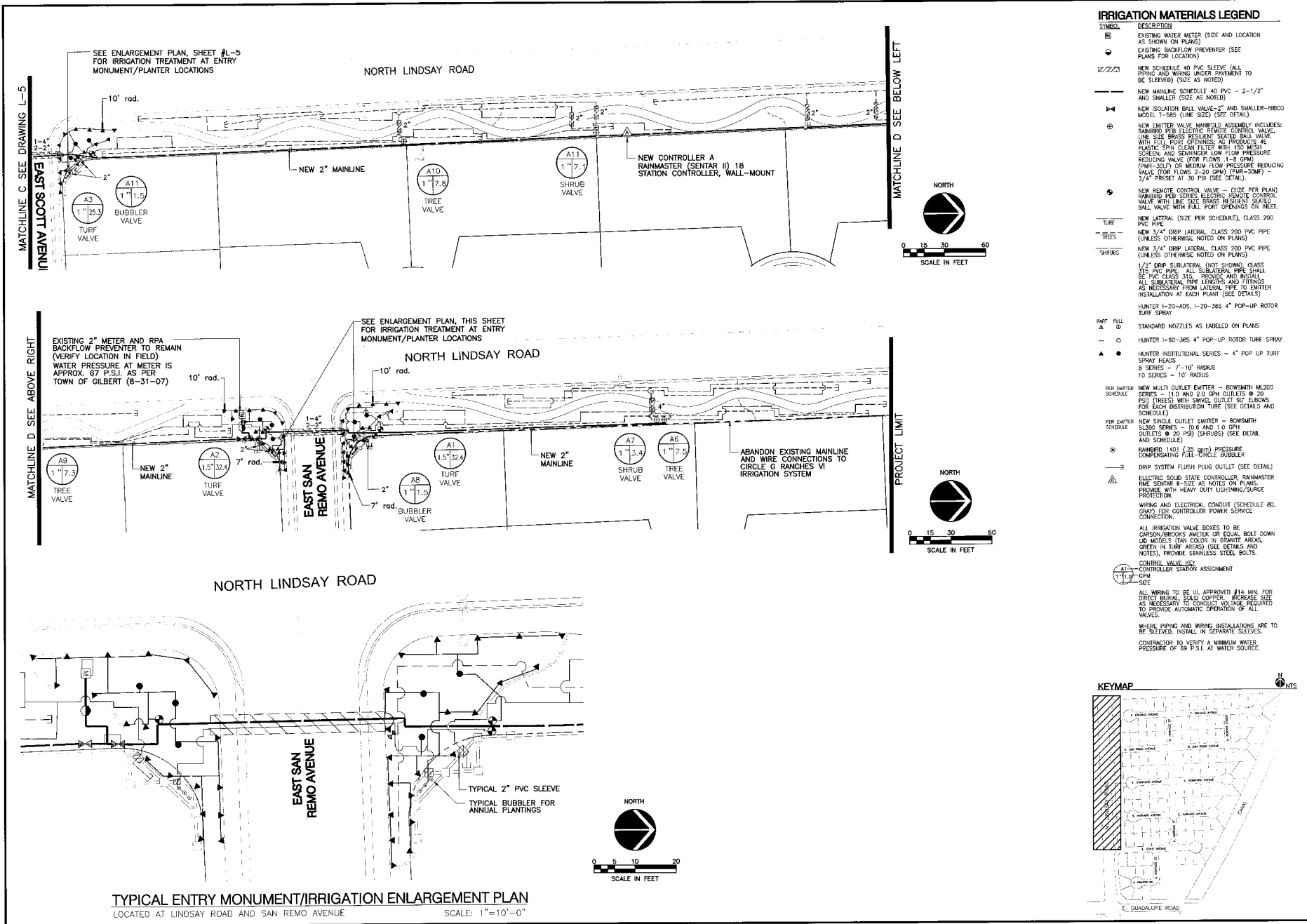

IRRIGATION MATERIALS LEGEND

- | SYMBOL | DESCRIPTION |
|--|--|
| EXISTING WATER METER (SIZE AND LOCATION AS SHOWN ON PLANS) | EXISTING BACKFLOW PREVENTER (SEE PLANS FOR LOCATION) |
| NEW SCHEDULE 40 PVC SLEEVE (ALL PIPING AND WIRING UNDER PAVEMENT TO BE SCHEDULED) (SIZE AS NOTED) | NEW MAINLINE SCHEDULE 40 PVC - 2-1/2" AND SMALLER (SIZE AS NOTED) |
| NEW ISOLATION BALL VALVE-2" AND SMALLER-NECO MODEL 1-585 (LINE SIZE) (SEE DETAIL) | NEW EMITTER VALVE MANIFOLD ASSEMBLY INCLUDES: RAINBIRD PER ELECTRIC REMOTE CONTROL VALVE, LINE SIZE BRASS RESULTANT SEATED BALL VALVE WITH FULL PORT OPENINGS, 4C PRODUCTS 4C PLASTIC 5/8" CLEAN FILTER WITH 150 MESH SCREEN, AND SENSINGER LOW FLOW PRESSURE REDUCING VALVE (FOR FLOWS 1-8 GPM) (PWR-30E) OR MEDIUM FLOW PRESSURE REDUCING VALVE (FOR FLOWS 2-20 GPM) (PWR-30ME) - 3/4" PRESET AT 30 PSI (SEE DETAIL) |
| NEW REMOTE CONTROL VALVE - (SIZE PER PLAN) RAINBIRD PER ELECTRIC REMOTE CONTROL VALVE, LINE SIZE BRASS RESULTANT SEATED BALL VALVE WITH FULL PORT OPENINGS ON INLET. | NEW LATERAL (SIZE PER SCHEDULE), CLASS 200 PVC PIPE |
| NEW 3/4" DRIP LATERAL, CLASS 200 PVC PIPE (UNLESS OTHERWISE NOTED ON PLANS) | NEW 3/4" DRIP LATERAL, CLASS 200 PVC PIPE (UNLESS OTHERWISE NOTED ON PLANS) |
| 1/2" DRIP SUBLATERAL (NOT SHOWN), CLASS 105 PVC PIPE - ALL SUBLATERAL PIPE SHALL BE PVC CLASS 115. PROVIDE AND INSTALL ALL SUBLATERAL PIPE LENGTHS AND FITTINGS AS NECESSARY FROM LATERAL PIPE TO EMITTER INSTALLATION AT EACH PLANT (SEE DETAILS) | HUNTER I-25-ADS, I-20-365 4" POP-UP ROTOR TURF SPRAY |
| STANDARD NOZZLES AS LABELED ON PLANS | HUNTER I-60-365 4" POP-UP ROTOR TURF SPRAY |
| HUNTER INSTITUTIONAL SERIES - 4" POP UP TURF SPRAY HEADS
8 SERIES - 7'-10" RADIUS
10 SERIES - 10" RADIUS | NEW MULTI OUTLET EMITTER - BOWSMITH M200 SERIES - 1.0 AND 2.0 GPM OUTLETS @ 20 PSI (TREES) WITH SWIVEL OUTLET 90° ELBOWS FOR EACH DISTRIBUTION TUBE (SEE DETAILS AND SCHEDULE) |
| NEW SINGLE OUTLET EMITTER - BOWSMITH S200 SERIES - 1.0 AND 1.0 GPM OUTLETS @ 20 PSI (SHRUBS) (SEE DETAIL AND SCHEDULE) | RAINBIRD 1401 (25 gph) PRESSURE COMPENSATING FULL-CIRCLE BUBBLER |
| DRIP SYSTEM FLUSH PLUG OUTLET (SEE DETAIL) | ELECTRIC SOLID STATE CONTROLLER, RAINMASTER PER SENTAR II-SIZE AS NOTED ON PLANS. PROVIDE WITH HEAVY DUTY LIGHTNING/SURGE PROTECTION. WIRING AND ELECTRICAL CONDUIT (SCHEDULE 80, GRY) FOR CONTROLLER POWER SERVICE CONNECTION. |
| ALL IRRIGATION VALVE BOXES TO BE CARSON/BROOKS AMETEK OR EQUAL BOLT DOWN 10 MODELS (TAN COLOR IN GRANITE AREAS, GREEN IN TURF AREAS) (SEE DETAILS AND NOTES). PROVIDE STAINLESS STEEL BOLTS. | CONTROL VALVE KEY
CONTROLLER STATION ASSIGNMENT
GPM
SIZE |
| ALL WIRING TO BE UL APPROVED #14 MN FOR DIRECT BURIAL. SOLID COPPER - INCREASE SIZE AS NECESSARY TO CONDUCT VOLTAGE REQUIRED TO PROVIDE AUTOMATIC OPERATION OF ALL VALVES. | WHERE PIPING AND WIRING INSTALLATIONS ARE TO BE SCHEDULED, INSTALL IN SEPARATE SCHEDULES. |
| CONTRACTOR TO VERIFY A MINIMUM WATER PRESSURE OF 69 P.S.I. AT WATER SOURCE. | |

REV.	DATE	DESCRIPTION



McCloskey + Peltz, Inc.
 LANDSCAPE ARCHITECTS
 One West Blvd, Second Suite 110
 Tempe, Arizona 85281
 Phone: (480) 834-7171
 Fax: (480) 834-7177

Irrigation Plan
 Parkway Improvement District 07-6
CIRCLE G MEADOWS III
 PREPARED FOR: Town of Gilbert

DESIGNED BY: MP1
 DRAWN BY: MP1
 CHECKED BY: DCM
 PROJECT NO: 06422
 DATE: 1/2/08

DRAWING NO.
L-7
 SHEET 7 OF 14

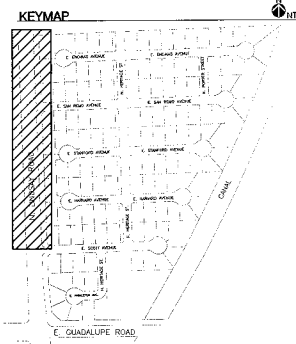

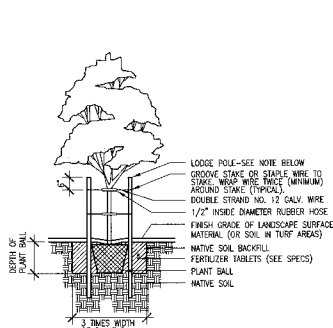

- NOTES:**
- HEIGHT OF STAKE VARIES. TOP BE PLACED FOR MAX. SUPPORT. BOTTOM BE PLACED HALFWAY BETWEEN TOP OF THE AND GRADE. SEE TREE STAKING DETAIL.
 - ONLY STAKE TREES THAT HAVE PREVIOUSLY BEEN STAKED IN THE NURSERY.
 - STAKES SHALL BE LOCATED AND INSTALLED SO AS TO NOT CONTACT THE ROOT BALL OR DAMAGE IRRIGATION SYSTEM WHEN DRIVEN INTO POSITION.

1 TREE PLANTING
N.T.S.

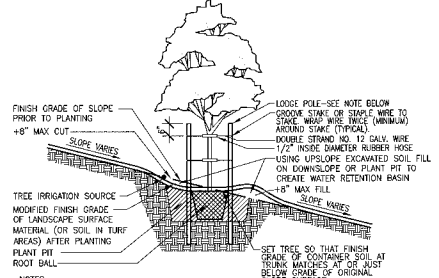

- NOTES:**
- PLANTING AND STAKING SHALL BE IN ACCORDANCE WITH DETAILS AND SPECIFICATIONS.
 - ALWAYS SET TREE TO MINIMIZE UPSLOPE CUT AND DOWNSLOPE FILL.
 - ROUND ALL CHANGES BETWEEN SURFACE SLOPE TRANSITIONS.
 - LOCATE IRRIGATION SOURCE ON UPSLOPE SIDE OF PLANT PIT.

2 TREE PLANTING ON SLOPE
N.T.S.

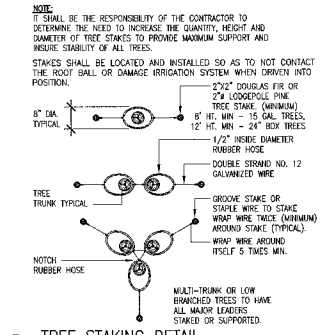

3 TREE STAKING DETAIL
N.T.S.

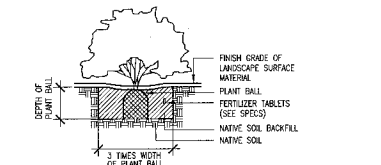

4 SHRUB PLANTING
N.T.S.

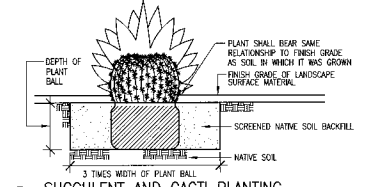

5 SUCCULENT AND CACTI PLANTING
N.T.S.

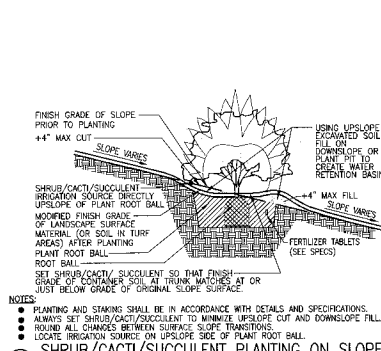

6 SHRUB/CACTI/SUCCULENT PLANTING ON SLOPE
N.T.S.

IF IMPERVIOUS SUBSURFACE CALICHE, ROCK OR HARDPAN EXISTS BENEATH EXCAVATED PLANT PIT, CONTRACTOR SHALL COMPLETE NECESSARY REMOVAL OR PENETRATION OF IMPERVIOUS MATERIAL TO PROVIDE NECESSARY PLANT PIT DRAINAGE AT A MINIMUM RATE OF 1 INCH PER HOUR. CONTRACTOR SHALL BE RESPONSIBLE FOR VERIFYING ADEQUATE PLANT PIT DRAINAGE PRIOR TO PLANT INSTALLATION.

ALL NATIVE SOIL BACKFILL WITHIN 18\"/>

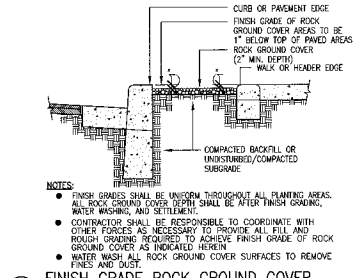

7 FINISH GRADE ROCK GROUND COVER
N.T.S.

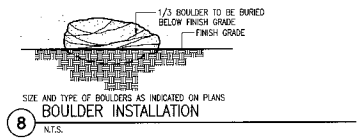

8 BOULDER INSTALLATION
N.T.S.

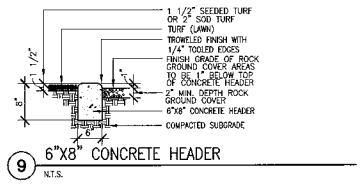

9 6\"/>

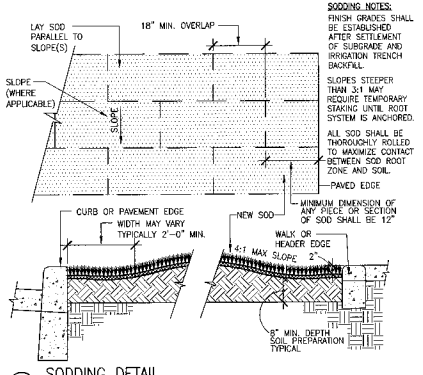

10 SODDING DETAIL
N.T.S.

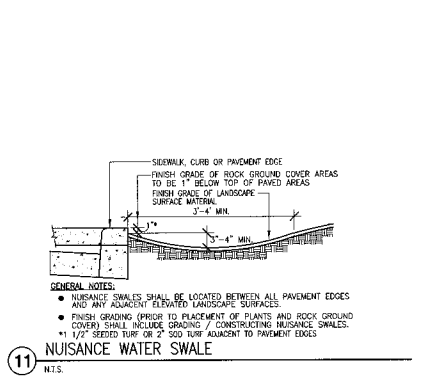

11 NUISANCE WATER SWALE
N.T.S.

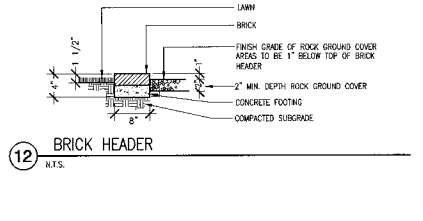

12 BRICK HEADER
N.T.S.

REVISIONS	NO.	DATE	DESCRIPTION



McCloskey + Peltz, Inc.
LANDSCAPE ARCHITECTS
One West Elm Street, Suite 110
Tempe, Arizona 85283
Phone: (480) 964-8771
Fax: (480) 961-1774

Landscape Details
Parkway Improvement District 07-6
CIRCLE G MEADOWS III
PREPARED FOR: Town of Gilbert

DESIGNED BY: **MP1**
DRAWN BY: **MP1**
CHECKED BY: **DCM**
PROJECT NO: **06422**
DATE: **1/2008**

DRAWING NO.
L-8
SHEET **8** OF **14**

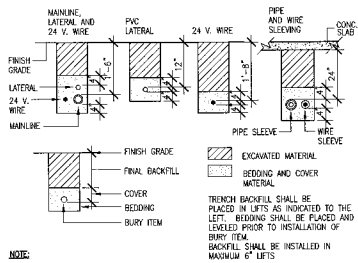

NOTE:

- SLEEVE ALL PIPE AND WIRE SEPARATELY.
- ALL PIPE TO BE INSTALLED PER MANUFACTURER'S SPECIFICATIONS. PLASTIC PIPE TO BE "SHAVED" IN TRENCHES. PROVIDE A MIN. OF 2" CLEARANCE TO SIDE OF TRENCH AND BETWEEN PIPES.
- ALL 120 V. WIRING SHALL BE INSTALLED IN ACCORDANCE WITH LOCAL CODE REQUIREMENTS. TAPE AND BUNDLE WIRES EVERY 10', PROVIDE LOOSE 20" LOOP AT ALL CHANGES OF DIRECTION OVER 10'.

1 IRRIGATION TRENCHING
N.T.S.

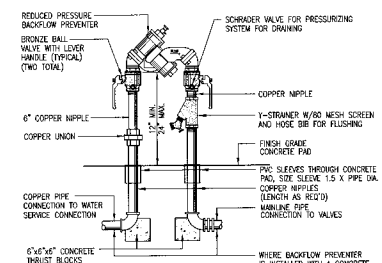

NOTE:

- LOCAL CODE SHALL COVER ALL INSTALLATION REQUIREMENTS.
- ALL CONNECTIONS SHALL BE COPPER OR TUBED BRASS.
- COORDINATE INSTALLATION OF CONCRETE SLAB AND BACKFLOW PREVENTER ENCLOSURE CASE IF INDICATED.

2\"/>

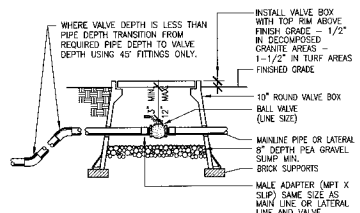

3 BALL VALVE/ISOLATION VALVE
N.T.S.

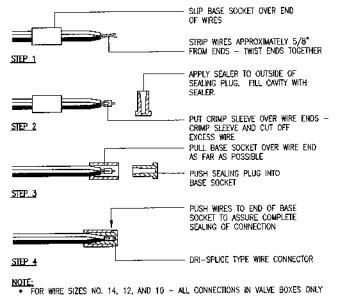

4 TYPICAL WIRE CONNECTION
N.T.S.

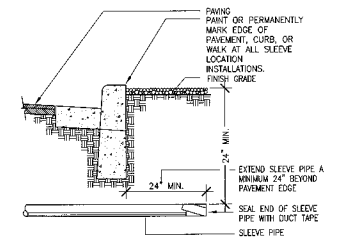

5 IRRIGATION SLEEVE
N.T.S.

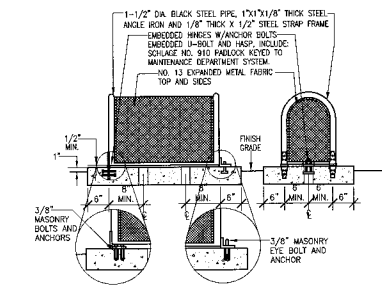

OPTIONAL NON-EMBEDDED HINGE INSTALLATION

- 6" THICK CONCRETE PAD SHALL HAVE TOP SURFACE SLOPED AT 1/2% W/ DRAIN FINISH. ALL OPENINGS IN PAD SHALL BE SLOVED WITH 1-1/2" (LARGER DIAMETER THAN PENETRATING PIPE) SIZE.
- THE ENCLOSURE SHALL BE SIZED, ANCHORED AND INSTALLED FOR UNRESTRICTED OPERATION, ACCESS AND CLEARANCE AROUND ITEMS ENCLOSED.
- ALL ANCHOR CONNECTION LOCATIONS AND HARDWARE TO BE TAMPER PROOF.
- WELD ALL JOINTS CONTIGUOUS AND GRIND SMOOTH ALL ROUGH SURFACES OR SHARP EDGES. PRIME AND PAINT ALL SURFACES W/ 2 COATS RUSTPROOF PAINT. SEE COLOR SELECTED BY OWNER. PROVIDE COLOR SAMPLE FOR SELECTION BY ARCHITECT.
- ALL ANCHORS AND HARDWARE TO BE STAINLESS STEEL.

6 BACKFLOW PREVENTER ENCLOSURE
N.T.S.

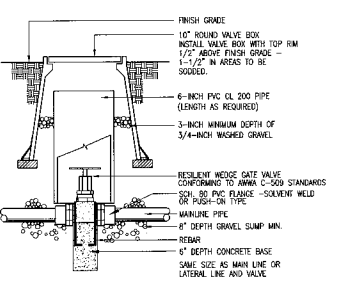

GENERAL NOTES:

- NOMINAL SIZE OF GATE VALVE TO MATCH NOMINAL SIZE.
- INSTALL A 4-INCH THICK CONCRETE PAD BELOW VALVE WITH NO. 4 REBAR WHEN USING PUSH ON TYPE VALVES.
- RESILIENT WEDGE GATE VALVE MAY HAVE EITHER MECHANICAL JOINT, PUSH-ON ENDS, OR FLANGE ENDS. THE OPERATOR IS A WRENCH NUT.

7 ISOLATION GATE VALVE
N.T.S.

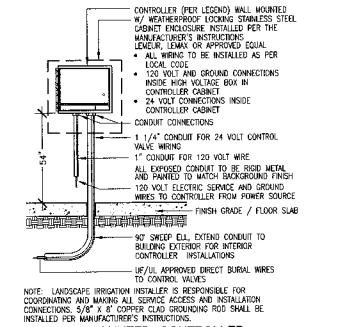

8 WALL MOUNTED CONTROLLER
N.T.S.

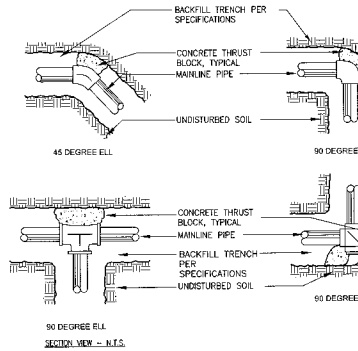

9 THRUST BLOCKS
N.T.S.

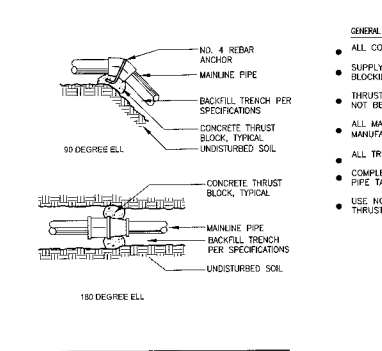

10 PEDESTAL MOUNTED CONTROLLER
N.T.S.

NOTE: PROVIDE SMOOTH EDGES FOR ALL CONCRETE AT THRUST BLOCKS TO AVOID DAMAGE TO PIPES.

REVISIONS	NO.	DATE	DESCRIPTION



McCloskey • Peltz, Inc.
LANDSCAPE ARCHITECTS
1810 BROADWAY
SUITE 110
SAN FRANCISCO, CA 94109
PHONE (415) 398-0777
FAX (415) 398-0174

Circle G Meadows III
Irrigation Details
Parkway Improvement District 07-6
PREPARED FOR: Town of Gilbert

DESIGNED BY: **MPI**
DRAWN BY: **MPI**
CHECKED BY: **DCM**
PROJECT NO: **06422**
DATE: **1/2008**

DRAWING NO:
L-9
SHEET **9** OF **14**

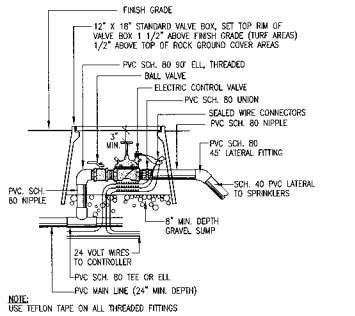

1 REMOTE CONTROL VALVE (TURF) (BUBBLERS)
N.T.S.

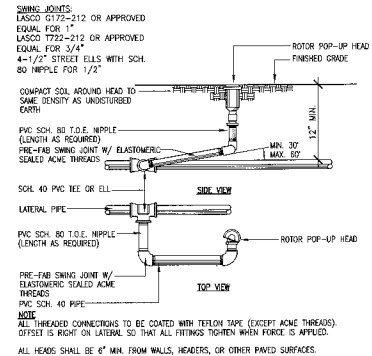

2 ROTOR HEAD W/ SWING JOINT
N.T.S.

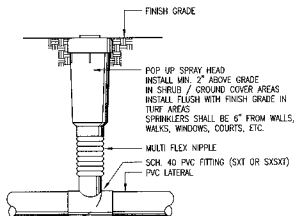

3 POP UP SPRAY HEAD
N.T.S.

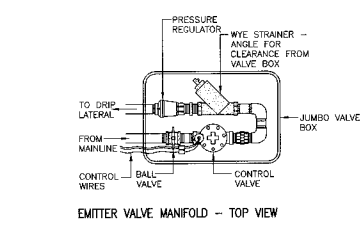

EMITTER VALVE MANIFOLD - TOP VIEW

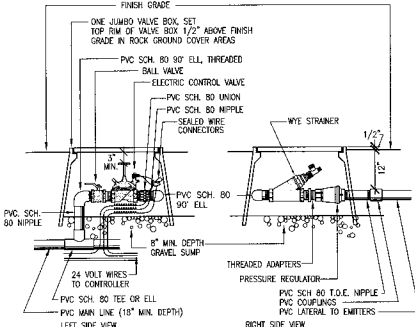

4 EMITTER VALVE MANIFOLD
N.T.S.

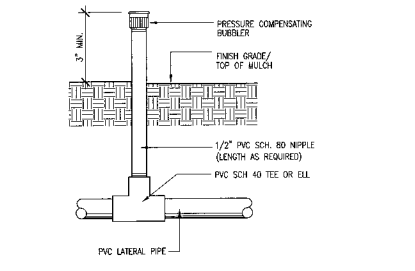

5 BUBBLER ASSEMBLY (ANNUALS)
N.T.S.

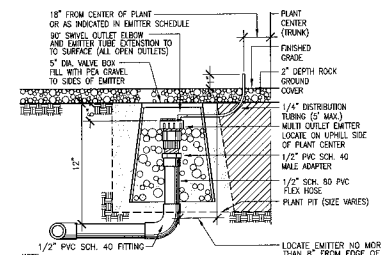

6 MULTI OUTLET EMITTER IN VALVE BOX
N.T.S.

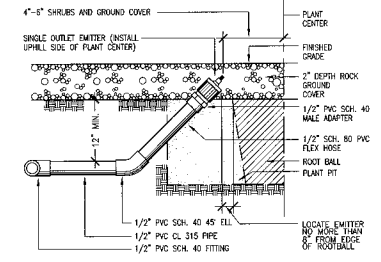

7 SINGLE OUTLET EMITTER
N.T.S.

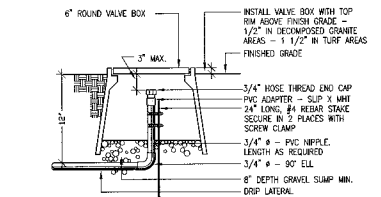

8 DRIP SYSTEM FLUSH PLUG
N.T.S.

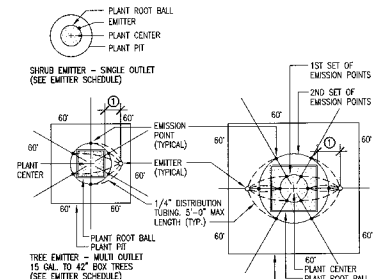

9 EMITTER LAYOUT
N.T.S.

TREES

TREE SIZE	NUMBER OF MULTI OUTLET EMITTERS - EMITTER GPH TOTAL	1ST SET OF EMISION POINTS	2ND SET OF EMISION POINTS
15 GAL.	1 - 1 GPH = 6 GPH	3 @ 12"	
24" BOX	1 - 1 GPH = 6 GPH	4 @ 18"	
30" BOX	1 - 1 GPH = 6 GPH	6 @ 21"	
35" BOX	1 - 2 GPH = 12 GPH	6 @ 21"	
42" BOX	1 - 2 GPH = 12 GPH	6 @ 21"	
48" BOX	2 - 2 GPH = 24 GPH	6 @ 12"	4 @ 42"
54" BOX	2 - 2 GPH = 24 GPH	6 @ 15"	5 @ 45"
EX. I.G. TREES	2 - 2 GPH = 24 GPH	6 @ 15"	6 @ 48"
DL TREES IN TURF	1 - 2 GPH = 12 GPH	6 @ 24"	6 @ 24"
EX. F. PALM	1 - 2 GPH = 12 GPH	6 @ 24"	

SHRUBS

PLANT	SIZE	EMITTER TYPE (G.P.H.)
ANGELICA BABY, WATIE'S BUELLIA, RAIN LAY, AND PINESTEM	ALL	.6 G.P.H. SINGLE OUTLET
ALL OTHER SHRUBS, GROUND COVER, AND ACCENTS	1 OR 5 GAL.	1 G.P.H. SINGLE OUTLET

10 EMITTER SCHEDULE
N.T.S.

PIPE SCHEDULE

PIPE SIZE	FLOW (OPM)	FLOW (GPM)
1/2"	0-4	0-5
3/4"	4-8	5-10
1"	8-13	10-15
1-1/4"	13-25	15-25
1-1/2"	25-30	25-30
2"	30-50	35-50
2-1/2"	55-70	65-80
3"	70-120	80-120
4"	120-200	120-200

11 PIPE SCHEDULE
N.T.S.

NO.	DATE	DESCRIPTION



McCloskey + Peltz, Inc.
LANDSCAPE ARCHITECTS
One Woodloch Forest Drive - 110
Troy, MI 48068-1177
Tel: (482) 317-7777

Irrigation Details
Parkway Improvement District 07-6
CIRCLE G MEADOWS III
PREPARED FOR: Town of Gilbert

DESIGNED BY: MPM
DRAWN BY: MPM
CHECKED BY: DCM
PROJECT NO: 06422
DATE: 1/2008

DRAWING NO:
L-10
SHEET 10 OF 14

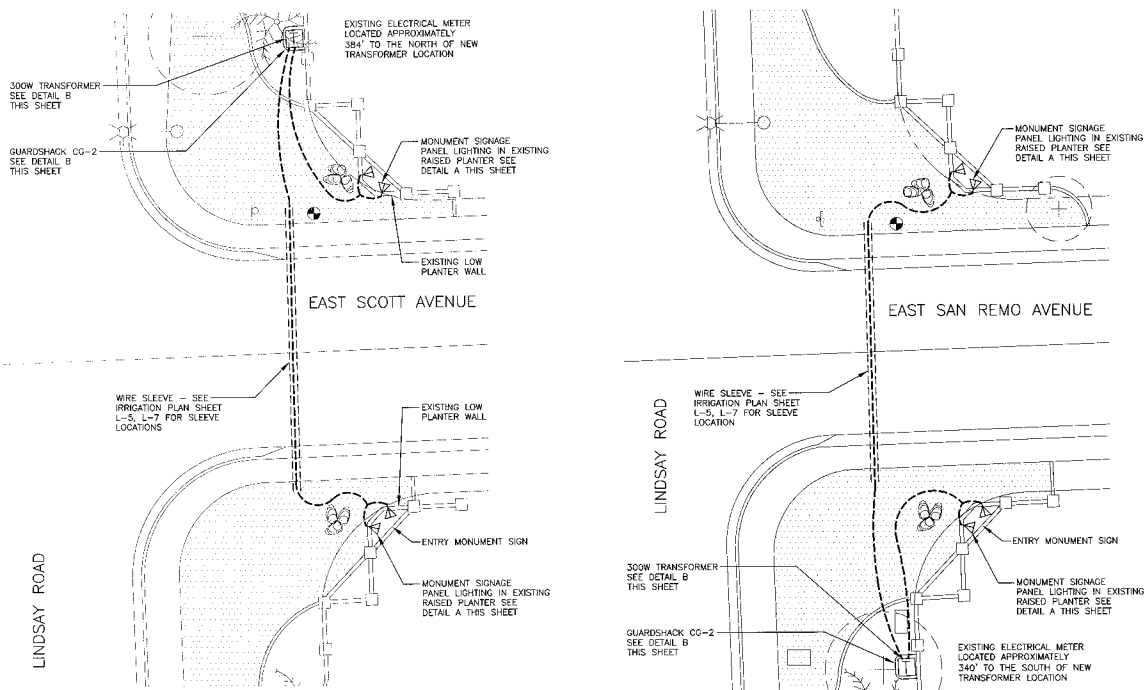

ENTRY MONUMENT PLAN VIEW

1"=10'-0"

LOW VOLTAGE LIGHTING DETAILS

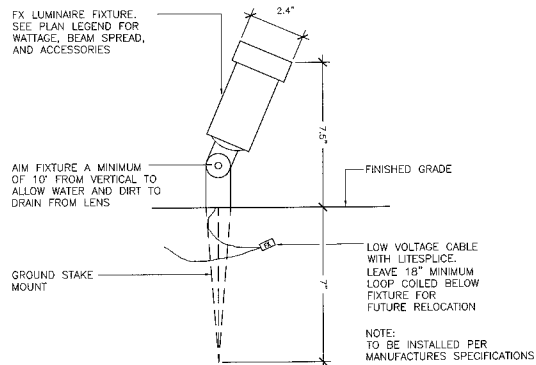

A MACCIA ULTIMO ON SPIKE MOUNT
N.T.S.

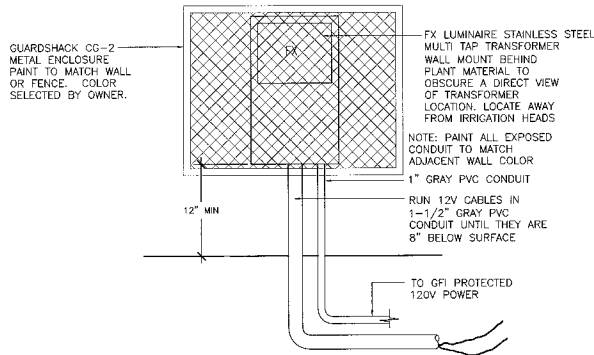

B TRANSFORMER WALL MOUNTED WITH METAL ENCLOSURE
N.T.S.

LOW VOLTAGE LIGHTING LEGEND

SEE THIS SHEET FOR LOW VOLTAGE LIGHTING DETAILS AND NOTES

SYMBOL	MANUFACTURER	MODEL	NOTES
LOW VOLTAGE LIGHTING			
△	FX LUMINAIRE	MU-20-W	SIGN LIGHT
□	FX LUMINAIRE	FX-300-TPC	OR APPROVED EQUAL
⌈	GUARDSHACK	CC-2	

UNLESS OTHERWISE NOTED, ALL LIGHTS NOTE: PROVIDE PLANT MATERIAL TO HAVE BRONZE FINISH TYP. SCREEN THE TRANSFORMER FROM VIEW TYP.

LOW VOLTAGE LIGHTING NOTES

GENERAL
Scope of Work: The supply and installation of a 12 volt landscape lighting system which includes the fixtures specified on Lighting Legend as well as the installation of low voltage transformers, conduit, and direct burial cable as necessary to complete the layout shown on plans. Lighting plans are diagrammatic and intended to show general fixture locations. Contractor is responsible for necessary line (120v) and low voltage (12v) work to complete the lighting design as shown.

Standards: All work performed is to comply with the National Electric Code and applicable local codes and ordinances. Contractor shall possess all necessary licenses to complete the described work. Contractor is to obtain all necessary permits to complete work described.

INSTALLATION
Contractor is to verify site measurements, grades, existing sleeves, existing plant locations, and existing utilities, equipment and switching controls. Contractor is to provide all necessary components and accessories to complete installation as specified.

- Direct Burial Cable:** Cable shown on plans is for fixture grouping only. Cable to be sized and sized to provide a minimum of 10.5 volts and a maximum of 11.5 volts to all lighting fixtures. Refer to FX Luminaire's "Routing Guidelines" included with the transformer. Minimum underground low voltage cable size is 12 gauge multi-strand direct burial. Install cable along edge of hardscape whenever possible. Minimum cable depth 8". All cable run under hardscape areas shall be installed in sleeves with sweep corners. Leave 24" loops at all future locations for field adjustment. All wire locations shall be waterproofed with FX Luminaire Spike connectors or APPROVED equal. Only fully encapsulated waterproof connectors rated for direct burial will be accepted. Black taped connections will be rejected.
- Fixture location:** Verify exact location with Landscape Architect or Owner's agent before commencing installation. All fixtures shall be in a new, unused condition. Equipment shall be the type specified - there will be no substitutions without prior approval from Landscape Architect or Owner's agent. Install all equipment as per manufacturer's specifications and details.
- Transformers:** Shall be FX Luminaire stainless steel Multi-Tap sized to be 80% loaded. Transformers to be installed inconspicuously using plant material or site features to obscure a direct view of their locations. Avoid locations that are easily accessible to children or that are in a direct path of irrigation water. Install transformers 12" above finish grade and level. All wires leading to or from transformer shall be in conduit sleeve that is firmly affixed to mounting surface. All junction boxes and other equipment shall be UL approved for wet locations. Paint transformers and any necessary junction boxes or conduit to match the surface on which they are mounted. Install transformers according to manufacturer's specifications and local codes. All exposed metal parts including transformers shall be permanently grounded in accordance with the National Electrical Code.
- Switches:** Contractor shall install switches at locations indicated on plan.
- Testing:** Contractor is to coordinate a convenient time in the evening to test and aim all equipment to the satisfaction of the Landscape Architect or Owner's agent.
- Guarantee:** Upon completion and acceptance of the described work, the Contractor shall provide a guarantee for all workmanship and equipment for the period of one year from the date of acceptance. All warranty service work shall be performed at no cost to Owner and be done in a timely fashion.
- As Built:** Contractor will provide Owner with complete and reproducible drawing of the system layout as it was actually installed. This drawing should include the location of underground cable, sleeves, and all fixtures and equipment.

FX LUMINAIRE CONTACT: GREG REDLAWSK
PHONE: 1-888-711-7963
FAX: 1-856-535-1234
EMAIL: greg@fxl.com

NOTE:
ALL LOW VOLTAGE LIGHTING SHALL BE ON AN AUTOMATIC TIMER AND SHALL BE EXTINGUISHED BETWEEN THE HOURS OF MIDNIGHT AND SUNRISE.
NOTE:
ELECTRICAL METER/ POWER SOURCE IS EXISTING, FIELD VERIFY.

KEYMAP

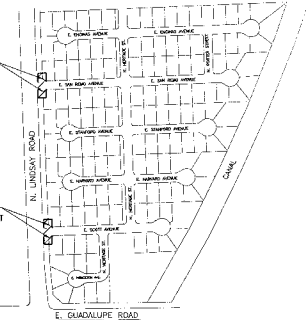

NO.	DESCRIPTION	DATE



McCloskey • Peitz, Inc.
LANDSCAPE ARCHITECTS
1100 S. GARDEN AVENUE, SUITE 110
PUEBLO, CO 81007
PHONE: (303) 863-9777
FAX: (303) 863-9774

Low Voltage Lighting Plan
Parkway Improvement District 07-6
CIRCLE G MEADOWS III
PREPARED FOR: Town of Gilbert

DESIGNED BY: MPI
DRAWN BY: MPI
CHECKED BY: DCM
PROJECT NO: 06422
DATE: 1/2008

DRAWING NO.
L-11
SHEET 11 OF 14

